



PREFAB HOUSE – ONE STOP SERVICE



K house

USAGE:

It can be used as office, meeting room, dormitory, shop, exhibition center, classroom etc. Which is in the fields of building, railway, highway, water conservancy project, electric power, business, tourism and military, etc.



Dormitory labor camp project in UAE

House Styles



One floor K house



Two floors K house



Remark:

Prefab K House: one floor, two floors or three floors.
Panel: 50/75/100mm, EPS/ROCKWOOL/PIU/EPS sandwich panel

Type A: 7K×12K×6P Dormitory

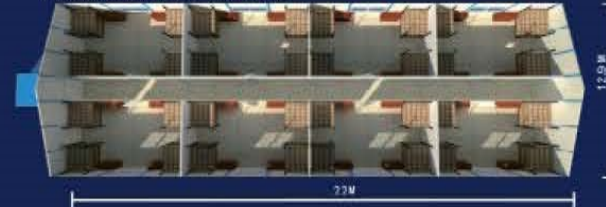

Type B: 3K×12K×3P Dormitory



Type C: 3K×12K×3P Dormitory



Type D: 4K×20K×3P Dormitory





Oman labor camp project



Canteen/dormitory/office



Qatar dormitory project



Dubai dormitory project



Inside design



The area comparing form of slope style house

K house:1K=1.82m,1P=0.95m

Length	Width	ONE FLOOR (3P)			TWO FLOOR (6P)			THREE FLOOR (9P)		
		3K	4K	5K	3K	4K	5K	3K	4K	5K
4	K	45.53	59.07	72.61	102.70	130.97	157.95	176.04	216.68	257.26
5	K	56.67	73.52	90.38	126.97	160.68	194.39	211.27	261.83	312.39
6	K	67.81	87.98	108.14	150.16	190.49	230.82	246.51	307.01	367.50
7	K	78.95	102.43	125.90	173.35	220.30	267.28	281.74	352.19	422.61
8	K	90.09	116.68	143.67	196.53	250.11	303.69	316.96	397.55	477.72
9	K	101.22	131.34	161.44	219.72	279.94	340.11	352.21	442.52	532.84
10	K	112.36	145.78	179.10	243.01	300.74	376.57	387.45	487.70	587.04
11	K	123.50	160.24	196.96	266.09	339.55	413.00	422.98	532.67	643.05
12	K	134.64	174.69	214.72	289.28	369.36	449.44	457.92	579.04	699.36
13	K	145.78	189.13	232.48	312.47	399.17	485.66	493.16	623.21	753.27
14	K	156.92	203.58	250.25	335.65	428.98	522.31	528.39	668.38	808.38
15	K	168.06	218.03	268.01	358.04	458.79	558.75	563.63	713.56	863.40
16	K	179.19	232.48	285.77	380.03	488.61	595.19	598.86	758.73	918.60
17	K	190.33	246.93	303.54	402.21	518.42	631.62	634.10	803.90	973.71
18	K	201.47	261.38	321.30	428.40	548.23	668.06	669.33	848.07	1028.82
19	K	212.61	275.84	339.06	451.59	578.04	704.49	704.57	894.25	1083.93
20	K	223.75	290.29	356.83	474.77	607.85	740.93	739.00	939.42	1139.04
21	K	234.89	304.74	374.59	497.96	637.66	777.37	775.04	984.59	1194.15
22	K	246.02	319.19	392.35	521.15	667.48	813.80	810.27	1029.76	1249.26

Explanation:

The two floor's house has two pcs stair in standard Each side of gable wall has one. The stair's area is 4.5m²/pc. The three floor stair is 10m²/pc. The area will increase or reduce according the stair's quantity.

The regular of area counting way:

- 1.The house area=Exterior wall length * exterior wall width * floor number
- 2.Standard stair 4.5m²/pc, corner stair special for three floors house: 16m²/pc.
- 3.Awning area house shadow area * 0.5.
4. Aisle (loss) area and room shadow area.
- 5.Total area = ① + ② + ③ + ④.
- 6.Expect the no standard house, this regular is suitable for all the house.
- 7.Above regular also is fit for the flat style house.

MAIN MATERIALS



A shape beam

Steel column

Decoration sheet

Wall panel

Roof panel

Canteen -T House Design



Japan Mitsubishi Canteen 50MX20MX6H



Qatar Canteen 62MX18.1MX4H

Type A: Two floors dormitory

Type B: Two floors dormitory

Type C: Two floors office



Other Funtions:



TOILET



KITCHEN



CANTEEN

Accessories

<p>DOOR</p> <p>Sandwich panel Steel Aluminum Roller shutter</p>				<p>WINDOW</p> <p>Aluminum Sliding Aluminum Shutter</p>	
<p>FLOOR</p> <p>Ceramic Tile PVC Tile</p>		<p>CEILING</p> <p>300 Aluminum 600 PVC</p>			
<p>Toilet</p> <p>Wash Basin Urinal Squat Toilet Sitting Toilet Shower Head Shower room</p>					
<p>ROOF</p> <p>Lighting tile Ventilation ball</p>			<p>WALL DECORATION</p> <p>Interior Wall External Wall</p>		

STEEL STRUCTURE HOUSE PROJECT CASES

Company—Oman Warehouse

规格尺寸: 30m*80m*6m(W*L*H)+17.1m*2m*3m—2605m²
 Specification: 30m*80m*6m(W*L*H)+17.1m*2m*3m—2605m²

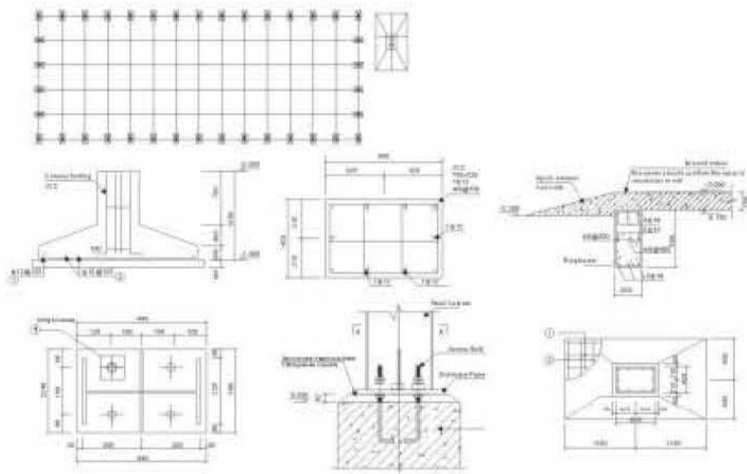

NOTE

- 1) ● H400 235 热轧 H 型钢 (I_y=2100mm⁴) ;
- 2) ● H300 335 热轧 H 型钢 (I_y=3000mm⁴) ;
- 3) ● H400 400 热轧 H 型钢 (I_y=3400mm⁴) ;
- 4) Foundation pit C10 subcut 100 from the steel structure C28

NOTE

- 1) If the ring beam can not connect the column (strongly connect), the size of the column can be increased appropriately, but the original design can not be affected. Please send it back to our engineer to confirm if you have any questions.
- 2) The appropriateness for material and China generalizations, the owner should determine whether it apply to the project according to the local soil conditions.
- 3) The risk device and practice above, we shall not be liable for any direct or indirect responsibility.

地基图 FOUNDATION DRAWING



18000m²
INDONESIAN SHIPYARD



3500m²
CONGO PROJECT



25000m²
THAILAND WAREHOUSE



8000m²
WILLEMSTAD SHOPPING MALL +
GARAGE ENTRANCE



18000m²
WORKSHOP, CLEANING ROOM



20000m²
MARSHALL PLANT



6500m²
GUINEA PLANT



20000m²
ZAMBIA PLANT



25000m²
NIGERIA PLANT



36000m²
MALAWI WAREHOUSE





Detachable Container House



DESCRIPTION

Portable Detachable Container is a new generation of prefab house. It is a whole unit itself, which can be used as a single portable house, or combined laterally or placed with layers. Detachable Container house can be connected by bolts, with easy installation and fast transportation. Life span is more than 20 years.



Easy to Install

ADVANTAGES

- Prefabricated**
All materials of Detachable Container has been prefabricated in factory (the roof, truss, column, wall panel, window and door, electronic system). The customer can install the house very easily and quickly. The prefabricated method significantly shorten the construction time in site. It meets the urgent need for site building. Government, military, construction company, etc.
- Modular**
The standard size of each unit Detachable Container is 2430mm*5200mm*2000mm. You can assemble several units container houses by horizontally and vertically based on your specific requirements. It can reach three floor.
- Environment-friendly**
The construction is dry work instead of the traditional brick and concrete building model so it will not cause pollution on the local natural environment. In addition the Detachable Container is portable and detachable so if you can take it away for the next use or new site.
- Excellent physical property**
The main structure of container house is galvanized steel frame and fire-proof glass wool (A grade fire-proof material) sandwich panel and has excellent performance in fire proof, sound insulation, heat preservation, earthquake resistance.
- Practical**
Dislikeless (sun, wet), suitable for AC and summer use, aluminum wire for light have been set inside of the roof panel and wall panel. Flexibility when fixing doors, windows and interior partitions.
- Delivery** One 40HQ shipping container can load 12 sets container houses (disassembly).
- Modern appearance, optional colors for the walls/panel and roof**
- Fast loading and convenient transportation**
- Safe strong and stable.**



Folding Container

ADVANTAGES

- ☑ Environment protective, no construction garbage caused.
- ☑ Repeated use and low cost.
- ☑ Flexible size and easy to assemble and disassemble.
- ☑ Long life span.
- ☑ Safe and durable, can stand 8 grade earthquake.
- ☑ Transportation convenient.
- ☑ Doors, windows and interior partitions can be fixed flexibly.
- ☑ Waterproof, fireproof & heat insulation.
- ☑ Flexible layout to satisfy different requirements.
- ☑ Manufacture with high quality control.
- ☑ Anti vibration, good impact resistance.
- ☑ Nice appearance, easy to maintenance.
- ☑ Installation instruction and video for you, technicians will help you if it's necessary.



- 1) Specification: Folding size: 2600mm*2600mm*380mm (H)
Expanding size: 2600mm*5800mm*2600mm (H)
- 2) Loading: 40 high cube load 12 units
- 3) Weight: 1.3tons
- 4) Bearing load: 150kg/square meters
- 5) Wind resistance: Grade 11 (wind speed ≤ 120km/h)
- 6) Earthquake resistance: Grade 8
- 7) Temperature resistance: -25°C to 55°C
- 8) Life span: 15 years
- 9) Build time: 2 people finish in 10 minutes

PRODUCT DETAILS

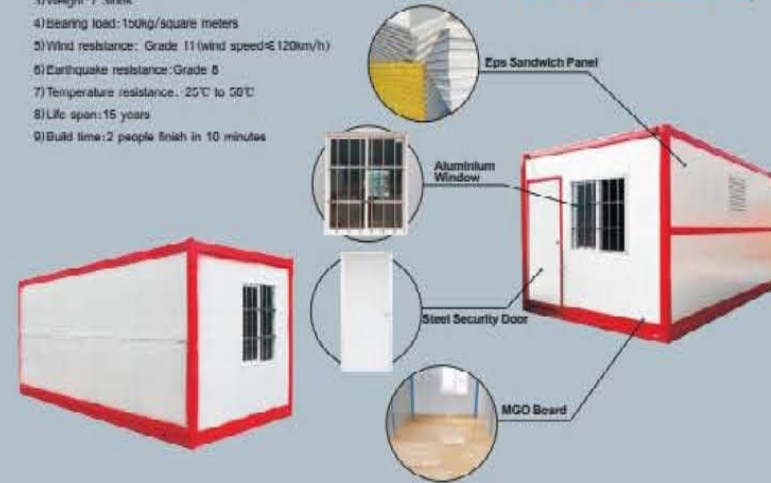

USE

House/office/hotel/dormitory/coffee shop/selling kiosks/ labor camp/refugee camp/restaurant, etc.





Flat Pack

Container House



Size: 2.4MX6MX2.89H

- FEATURES:**
1. Galvanized steel structure.
 2. 60mm Glass wool sandwich panel for wall & roof.
 3. Double glass aluminum sliding windows with anti-mosquito nets.
 4. Steel door.
 5. 18mm cement board & PVC tiles for floor.
 6. 1*40HQ can load 6 sets.



flat pack looking



wall panel



LIGHT STEEL VILLA



Concrete villa

The steel framed housing system has several obvious advantages being light weight, wide span, resistant to strong winds and earthquakes, providing greater thermal comfort and provide excellent noise reduction performance. It is a highly efficient, energy saving, environmentally friendly, sustaining green building system and can be fire rated. It can be used in various residential styles, such as villas, multi-storey buildings, entertainment centers and clubs. It also can be used in adding an extra floor on existing buildings, re-roofing or adding light partitions and external claddings. ANMEDIE can be exported and wall frames pre-assembled and external claddings, insulation and windows already attached. Trusses can also be supplied Pre-assembled, making installation times significantly quicker than conventional construction methods.

Moreover, BlueScope Lysaght Residential provides many standard classical villa styles. Developers can not only choose from the standard designs, but can also have them customized, if required. Using advanced design software, we will provide the optimized solutions to meet customers' needs with lower cost and high efficiency.



Portable toilets

Portable toilet A:



Portable toilet B:



Portable toilet C:



Portable toilet D:



Security box

