

FRONT VIEW

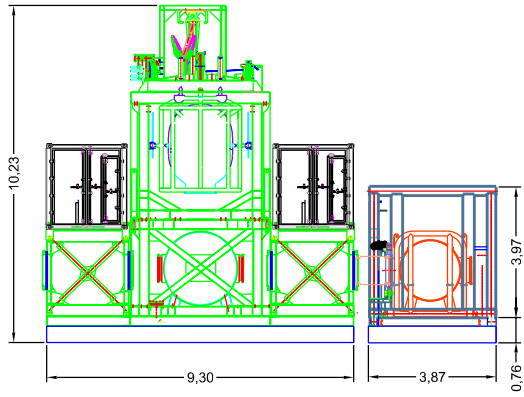

LONGITUDINAL VIEW

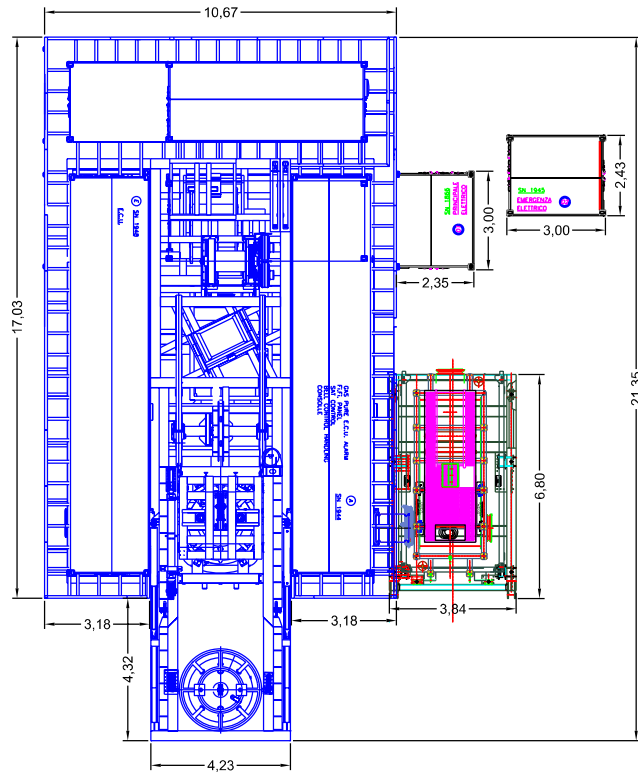
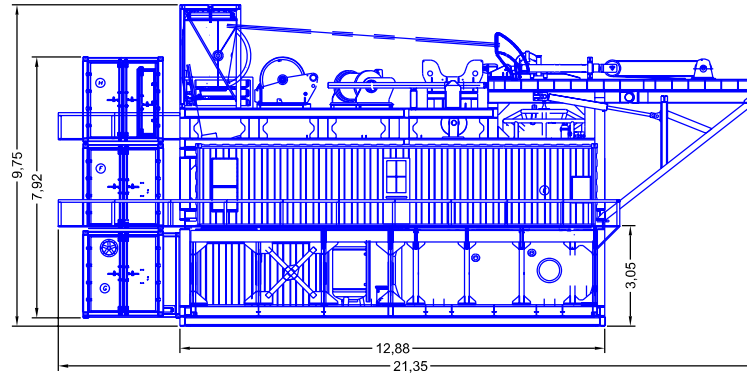

TOP VIEW

HRC SIDE VIEW

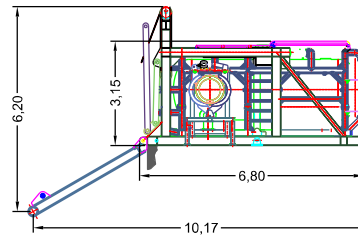

DIVING SYSTEM MAIN DATA

NUMBER OF DIVERS :	12 (9 OPERATIVE + 3 DECO)
MAX. WORKING DEPTH :	300m
SIGNIF. WAVE HEIGHT :	4m
D.A.P. :	1g IN VERTICAL DIRECTION, 1g IN LONGITUDINAL DIRECTION, 1g IN TRANSVERSAL DIRECTION
OVERALL DIMENSION :	15.8MWx21.3Lx5.4H m
OVERALL WEIGHT :	250 TONS
INSTALLATION :	ON MOON POOL OR ON SHIP SIDE, DISTANCE FROM BELL PROTECTION FRAME AND SHIP SIDE : 1.9 m

MAIN COMPONENTS :

- 6-MAN CHAMBER - TWIN LOCK, 2200mm INNER DIAMETER, INSULATED AND SS-CLADDED, ON TRANSPORT/INSTALLATION SKID, TOP FLANGE FOR BELL MATING
  - 3-MAN CHAMBER - TWIN LOCK, 2200mm INNER DIAMETER, INSULATED AND SS-CLADDED, ON TRANSPORT/INSTALLATION SKID
  - 3-MAN DIAC CHAMBER - TWIN LOCK, 2200mm INNER DIAMETER, INSULATED AND SS-CLADDED, ON TRANSPORT/INSTALLATION SKID
  - 3 DIVER DIVING BELL : 5.4 m, 1900mm INNER DIAMETER, BOTTOM MATING, FLOATING (DROP WEIGHT)
  - 40' 2.7.1 DNV CERTIFIED CONTAINER : SAT CONTROL ROOM AND DIVE CONTROL ROOM + HANDLING CONTROL
  - 40' 2.7.1 DNV CERTIFIED CONTAINER : 3 X CHAMBER ECUs
  - 30' 2.7.1 DNV CERTIFIED CONTAINER : FULLY REDUNDANT DIVER HOT WATER SUPPLY
  - 30' 2.7.1 DNV CERTIFIED CONTAINER : FILLING COMPRESSOR, RECLAIM BUFFER TANK AND SANITARY WATER SUPPLY
  - 20' 2.7.1 DNV CERTIFIED CONTAINER : GAS MANAGEMENT PANELS - DISTRIBUTION AND REDUCTION
  - 20' 2.7.1 DNV CERTIFIED CONTAINER : 2 DIVER RECLAIM SYSTEM
  - 10' 2.7.1 DNV CERTIFIED CONTAINER : 440/230V MAIN SWITCHBOARD
  - 10' 2.7.1 DNV CERTIFIED CONTAINER : 440/230V EMERGENCY SWITCHBOARD
  - BELL HANDLING SYSTEM - DNV LIFTING APPLIANCE CERTIFIED :-
1. GANTRY TYPE - OVERHEAD HYDRAULIC OPERATED TROLLEY SYSTEM. IF SYSTEM INSTALLED ON SHIP SIDE THE OUTER PART OF RAIL CAN BE FOLDED TO REDUCE THE OVERBOARD OCCUPATION.
  2. MAIN WINCH : 12 SWL, TWO MOTOR, TWO BAND BRAKE.
  3. GUIDE WIRE WINCH : 2.5 SWL (7.5 SWL IN EMERGENCY MODE) ONE MOTOR, TWO BAND BRAKE, INTENDED AS PRIMARY BELL EMERGENCY RECOVERY SYSTEM.
  4. UMBILICAL WINCH : CAPABLE OF STORING, DEPLOY AND RECOVER UP TO 400m OF 96mm MAIN UMBILICAL, CONSTANT TENSION MODE AVAILABLE.
  5. SHOCK ADSORBER : 100% FULLY REDUNDANT SHOCK ADSORBER SYSTEM FOR BELL AND CLUMP WEIGHT HANDLING.
  6. HPP : 2 SISTER UNITS, 1 PRIMARY AND 1 EMERGENCY. SWAPPING MANIFOLD PROVIDED.
- HRC : 12 MAN-72 HOURS AUTHONOMY AS PER SOLAS RULES. TILTABLE PLATFORM FOR LAUNCHING. POSSIBILITY TO INSTALL AS SHOWN OR 90° POSITION USING REAR MANHOLE. MAXIMUM LAUNCHING HEIGHT : 7m.

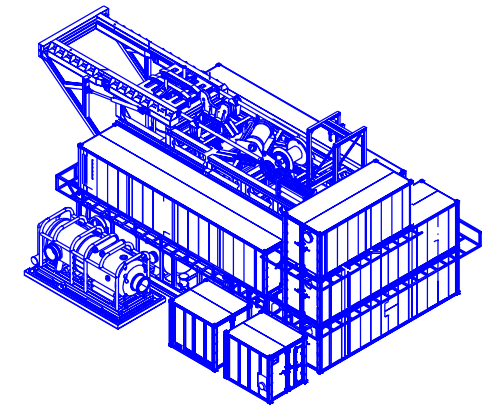

ISOMETRIC VIEW - OUT OF SCALE