



**EVERYTHING  
UNDER THE SUN**



## INTRODUCE

**Lightweight EPS module structure maximizes thermal insulation and sound insulation. Unique dome non-skeleton structure ensures the overall structure and gives residents a sense of security before hurricanes and earthquakes.**

**With its easy expansion and mobility, Dome House is applied to a wide range of facilities from mobile home, multiple-floor or two-story house, and marine pension to commercial buildings such as agricultural greenhouse, low-temperature warehouse, restaurant and cafe.**

### Economic Values

- Incredible time and cost savings thanks to its mobility and easy installation
- Time and cost effectiveness with short construction time of 25-30 days (based on 50 m<sup>2</sup>)

### Various Uses

- With 30 m<sup>2</sup> type as the basic offering, extending side to side is possible(patented).
- Simply by adding various area types, expansion can be made in various forms.

### Energy Saving

- 180mm thick EPS construction with best insulation
- A pleasant residential environment with just a small amount of energy.
- Over 30 to 60% energy saving for heating and cooling compared to existing constructions

### Nature-like Construction Type

- The harmony of arched curves and straight lines, creating natural beauty.
- The round interior giving psychological comfort, as if you were in your mother's arms.
- A romantic atmosphere where you can see the moon and the stars through the window on the ceiling.

### Durable structure against the external environment

- The dome structure, scientifically proven to be the safest, is strong against snow load with its strong compressive force and excellent durability.
- With its acute angle naturally undisturbed by winds, it is safe in areas even with heavy winds.

### Eco-friendly Materials

- Since EPS consists of only carbon and hydrogen, harmful materials and environmental hormone do not occur.
- It realizes perfect low-carbon, green energy.

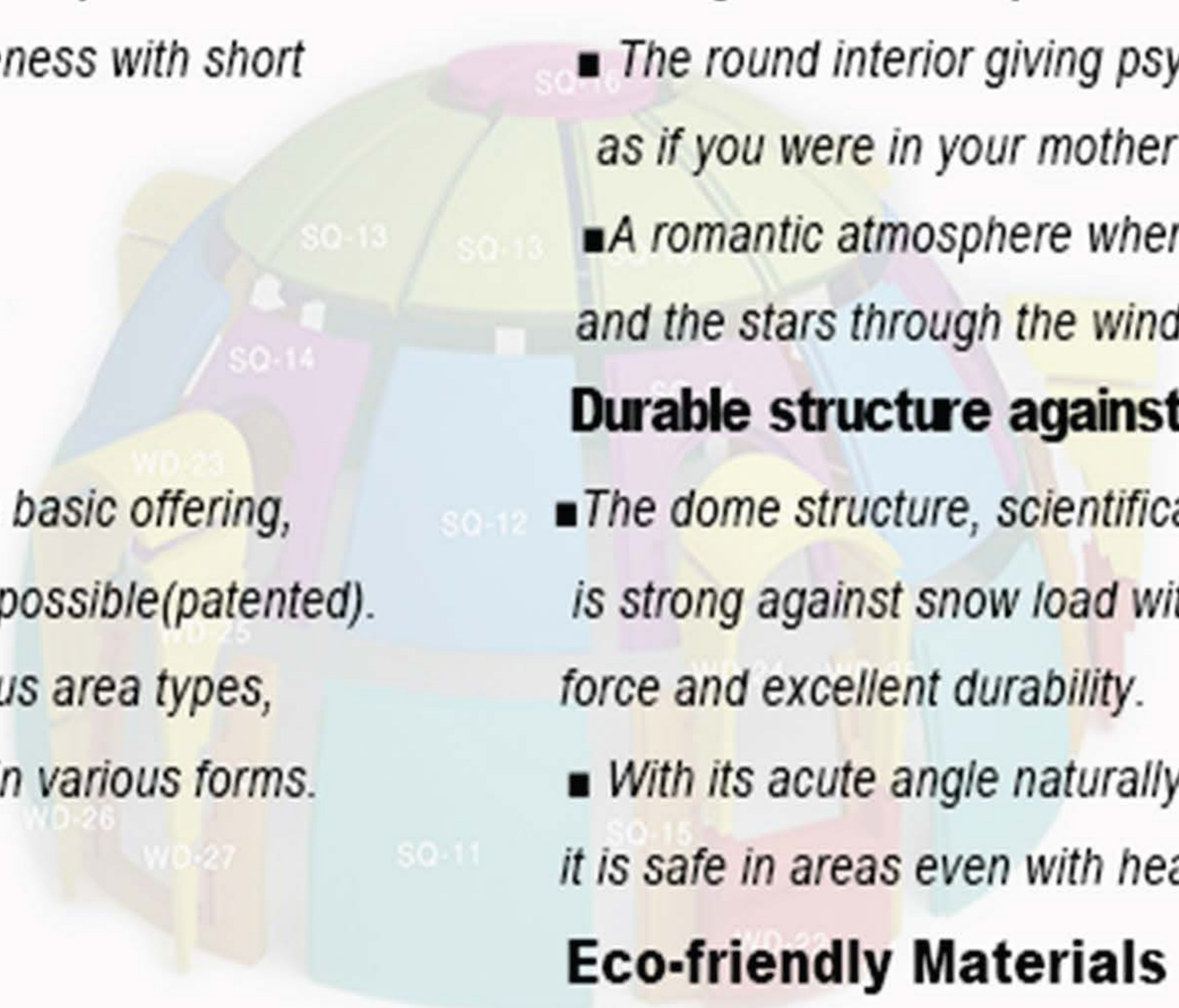



## MATERIAL

The insulating effect of EPS material maximizes energy saving.

Dome House is constructed with 180mm-thick external walls material combined with carbon and hydrogen. EPS material features water resistance keeping it from absorbing water in bubbles even in flooded condition for a long time, and it also has enough strength to be an alternative to wooden building material. Thus the technique of fundamentally eliminating the problem on load and earth pressure by using EPS block is widely used in constructing the retaining wall or in the site of poor ground and slope. Aside from such excellent strength and heat insulation, EPS also has outstanding self-extinguishing property, so it does not combust easily. Even if it is set on fire, as soon as the cause of fire is removed, self-extinguishing property prevents the spread of fire.



The walls of the dome house are limited combustible building materials certified by CE and SGS. They are fireproof, waterproof, moth-proof and corrosion-resistant, and do not produce disease house syndrome.

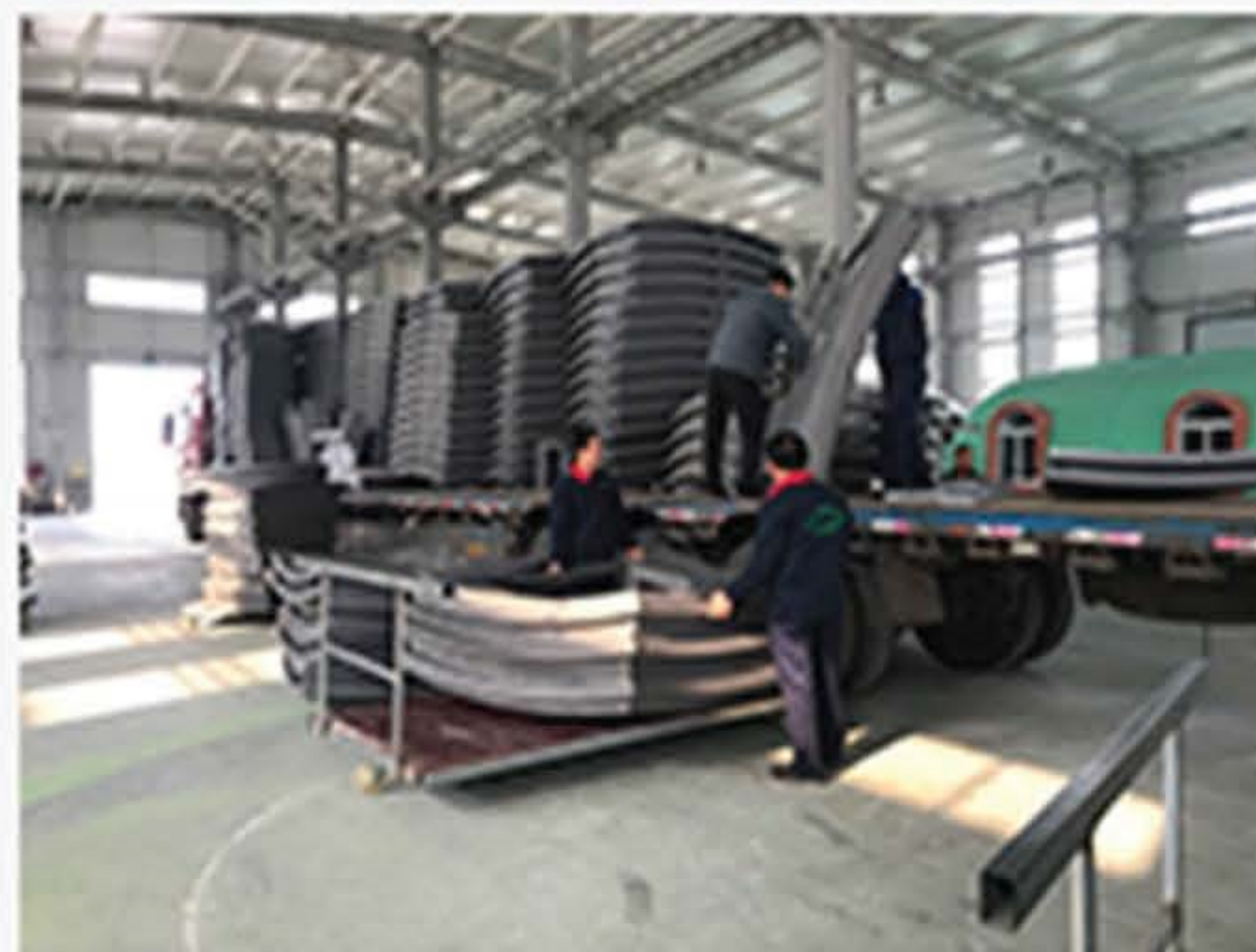

A multi-story protective system for domed houses

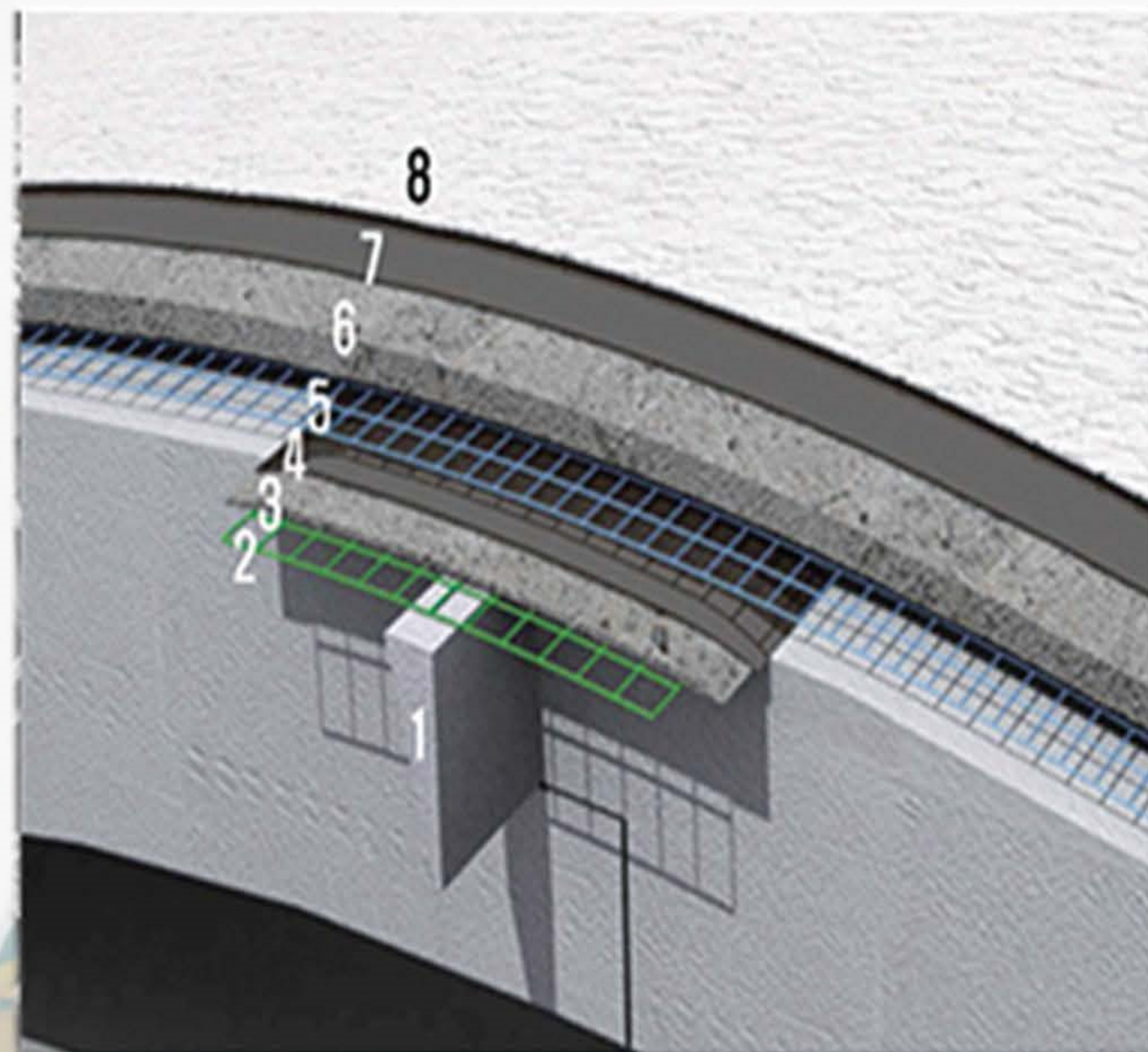



## INSTALLATION METHOD

**The Dome House's main material is 180mm thick, highly compressed, fire-resistant styrofoam (EPS). The interior and exterior of the high pressure polystyrene foam are made of mesh reinforced fibers and cement mortar. When dried, it hardens. Even if you hit the wall with a hammer, it won't crack. Interior finishes can be done with wallpaper or convenient coatings, exterior finishes, and various materials such as silicone paint, stone, or dryvit, depending on the owner's choice.**

**1. Foundation work**



**2. Structural module assembly**



**3. wall space**



**4. interior decoration**

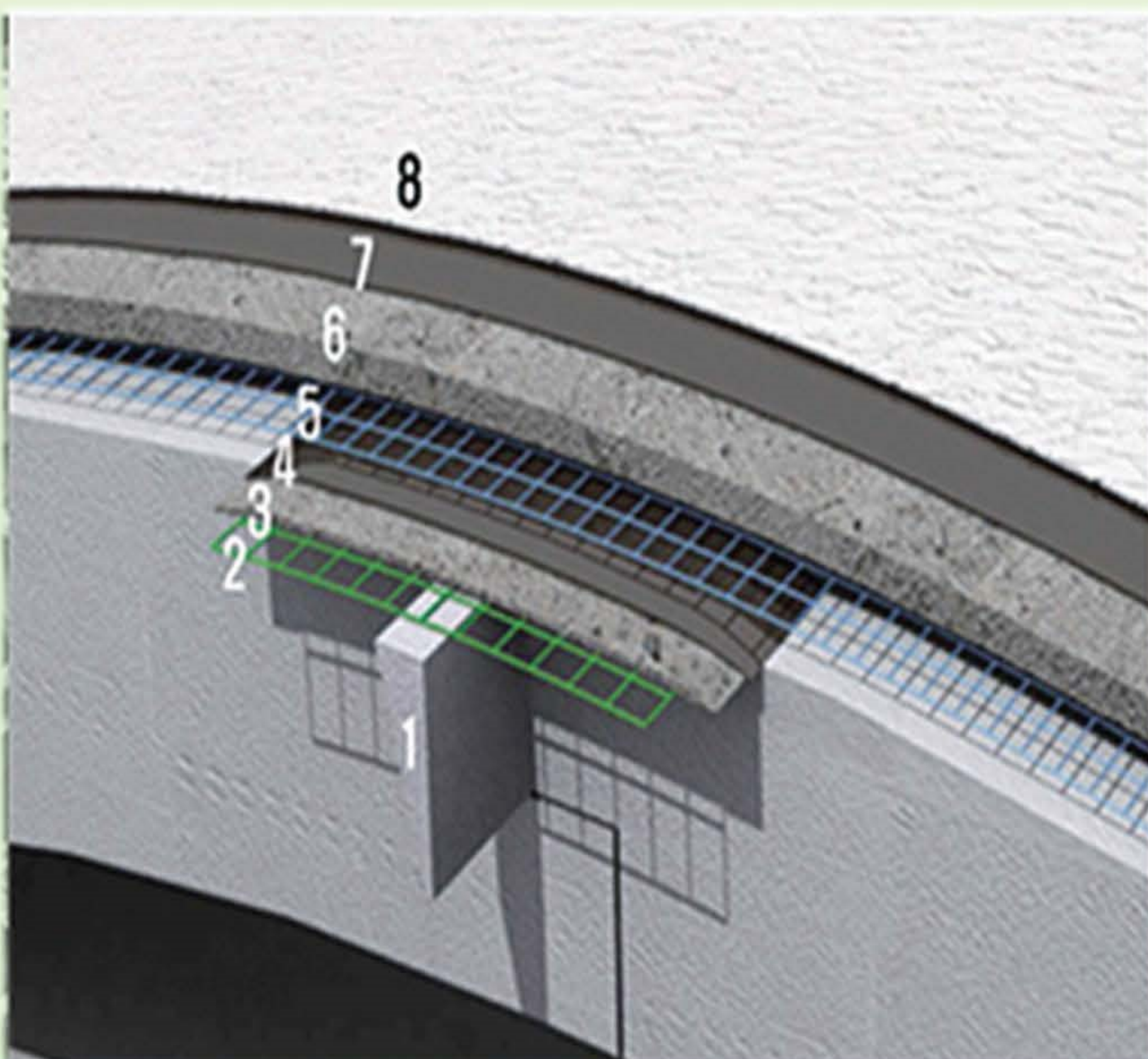

**Our panel is manufactured by double overlaying high-strength fabric mesh and environment-friendly mortar on 180mm thick, specially manufactured, highly compressed and flame-resistance treated Styrofoam wall. This shows excellent compressing result which is equivalent to compress 2000mm thick ordinary EPS.**





# BASIC TYPE

Basic house type : 27 m<sup>2</sup>

Basic house type 2: 50m<sup>2</sup>

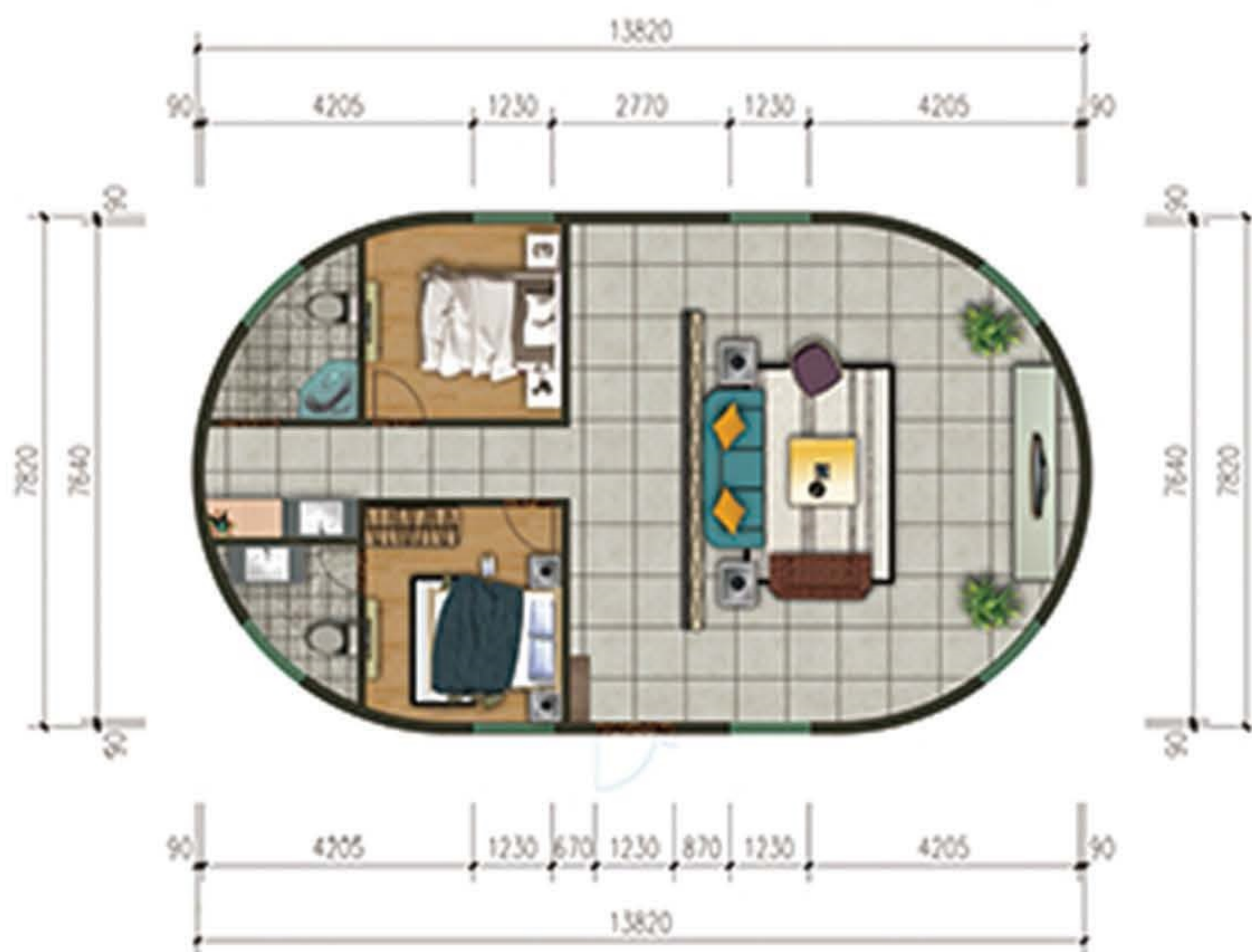



# GREENHOUSE

## Energy-Saving Greenhouse Pilot Complex



*greenhouse  
Cold storage warehouse  
Mushroom cultivation.  
Poultry farm  
Duck farm  
Pig farms, etc.  
Facilities should be kept  
at a certain temperature,  
Otherwise a sudden  
change in temperature  
will do no harm*



## Other applications





# COMBINATION TYPE



**Basic 26.4m<sup>2</sup> : Room 1**  
**Wide Window Type 49.5m<sup>2</sup> :**  
**Room 1, Living room, Bathroom**  
**26.4m<sup>2</sup> Type: Room 1**  
**Besides, various combinations are possible.**

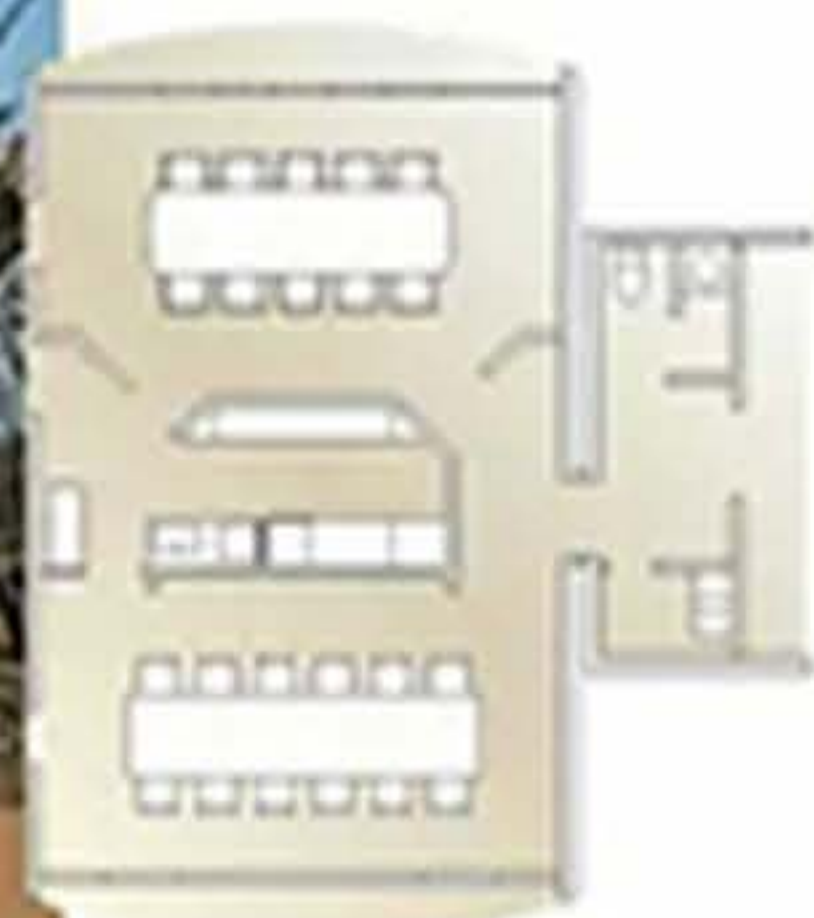
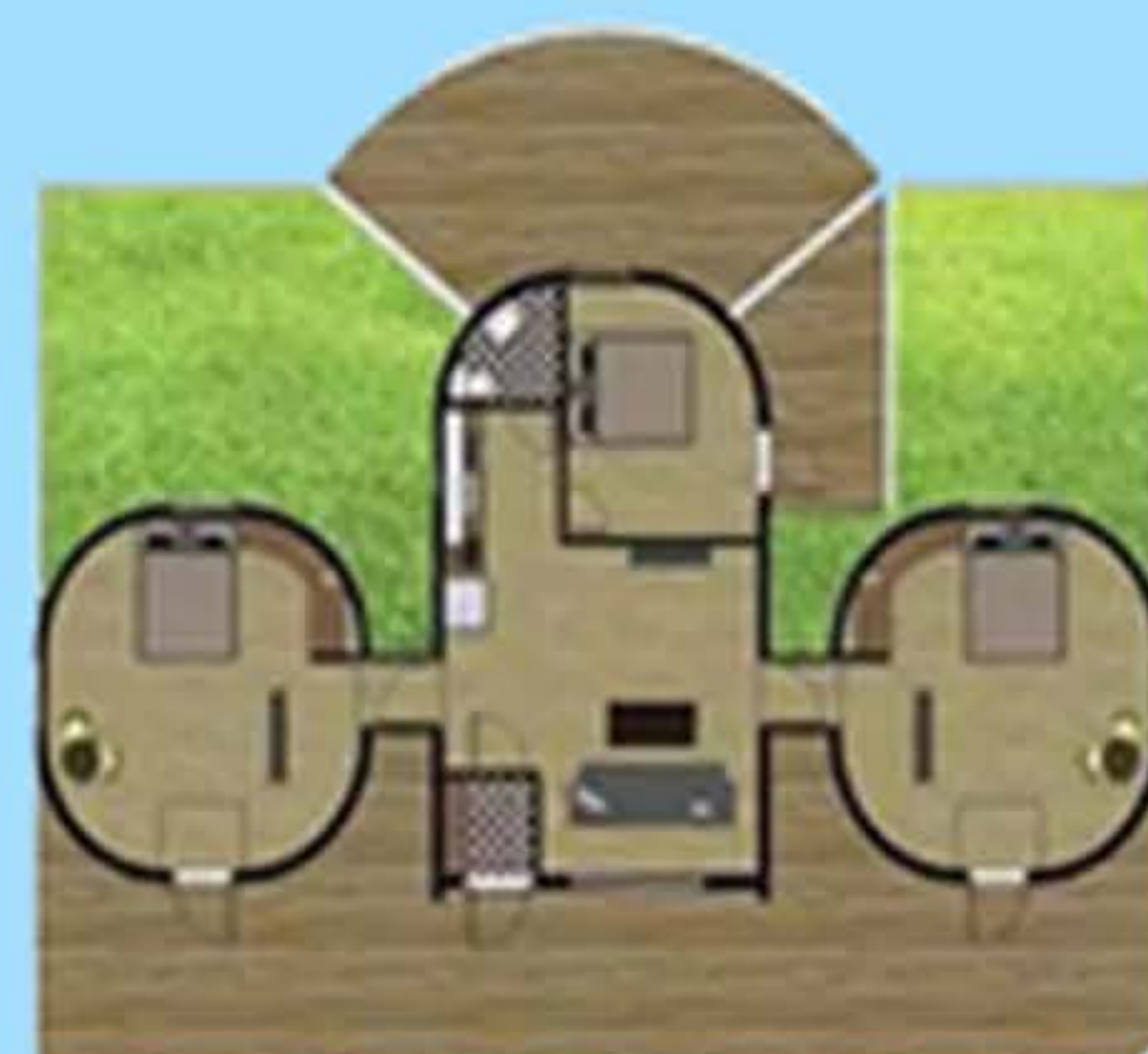



# TUNNEL TYPE



54.63m<sup>2</sup> (excluding front entrance)

Room 1/Bathroom 1/Living room 1

Protruding inner gate on the side



From basic type, all curves were removed; it was built with linear wall in all aspects. Interior space organization is convenient. It is appropriate for country house or detached house measuring more than 66m<sup>2</sup>.

- **Width** : Possible to choose from 5.59 m or 6.74 m
- **Length** : Possible to extend freely



## Building Example





# COMBINATION TYPE

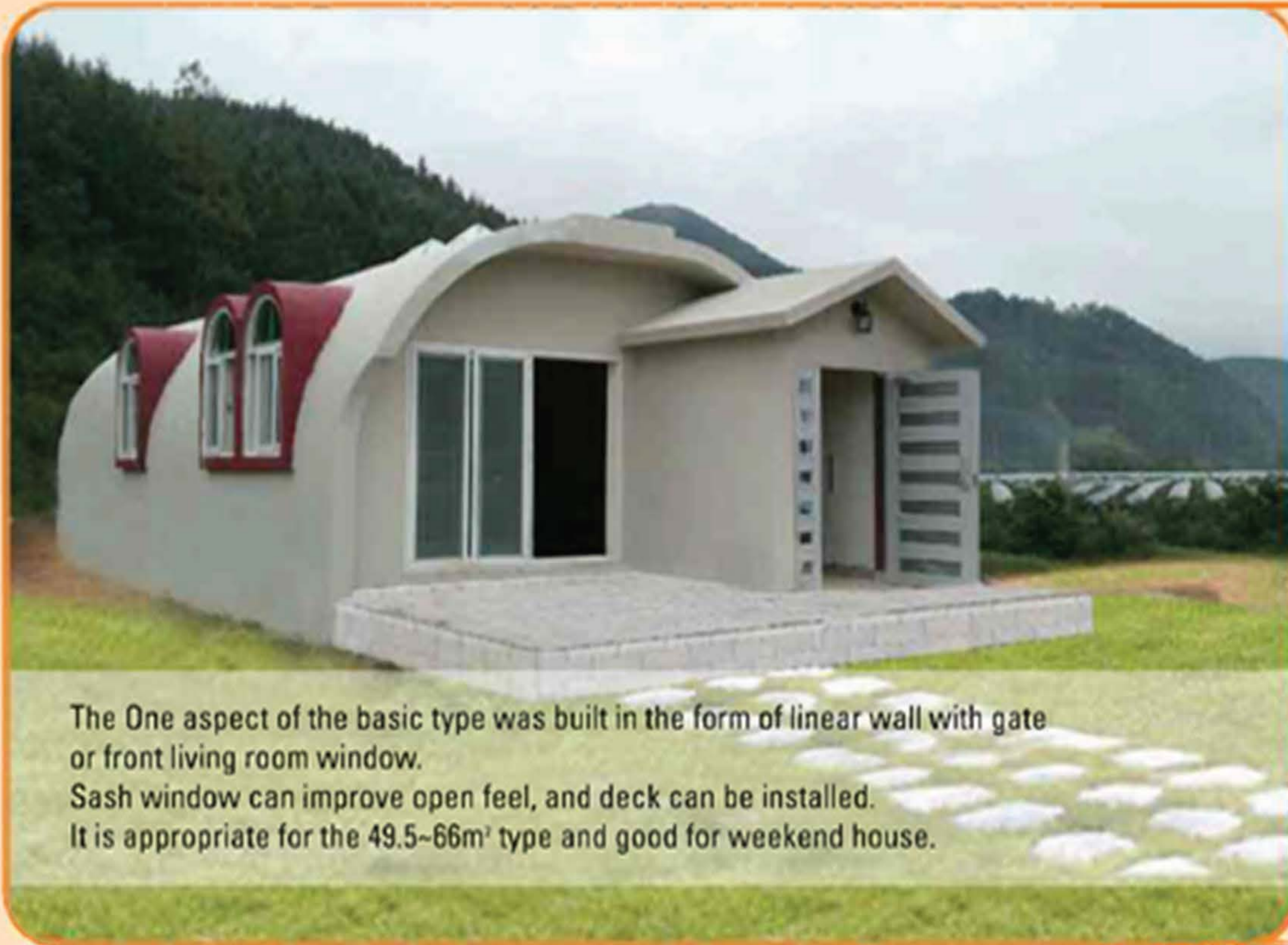

54.087 m<sup>2</sup> (excluding front entrance)  
Room 1/Bathroom 1/Living room1  
Protruding inner gate in wide window

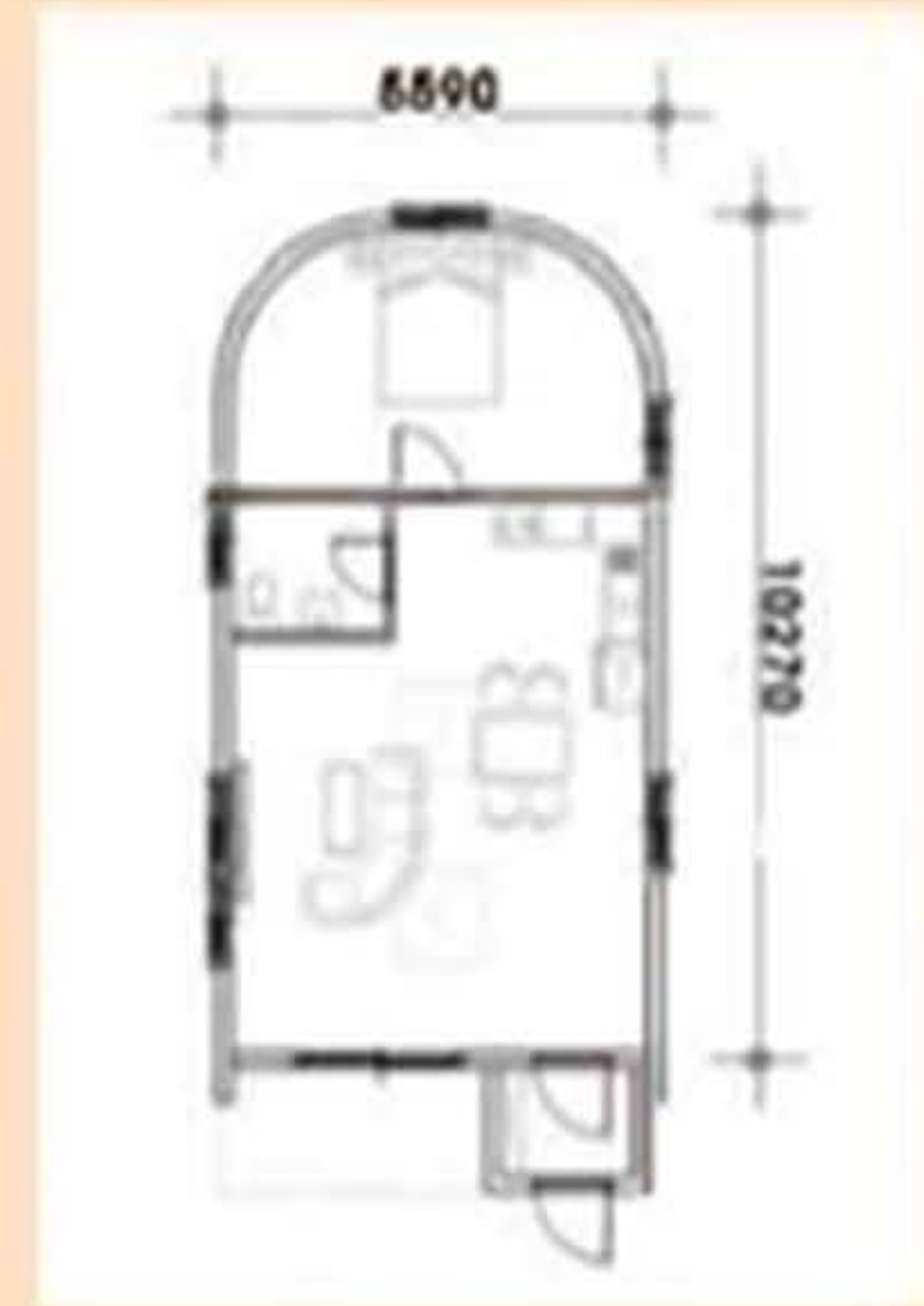

- Width : Possible to choose from 5.59 m or 6.74 m
- Length : Possible to extend freely



## Building Example

