

Project Content: Installation of the 120sqm light steel villa

Project Background: Through a long period of communicating and negotiating, the UK government required us to draw a design at first because it needs to be tested and certified in UK

Design Sketch:

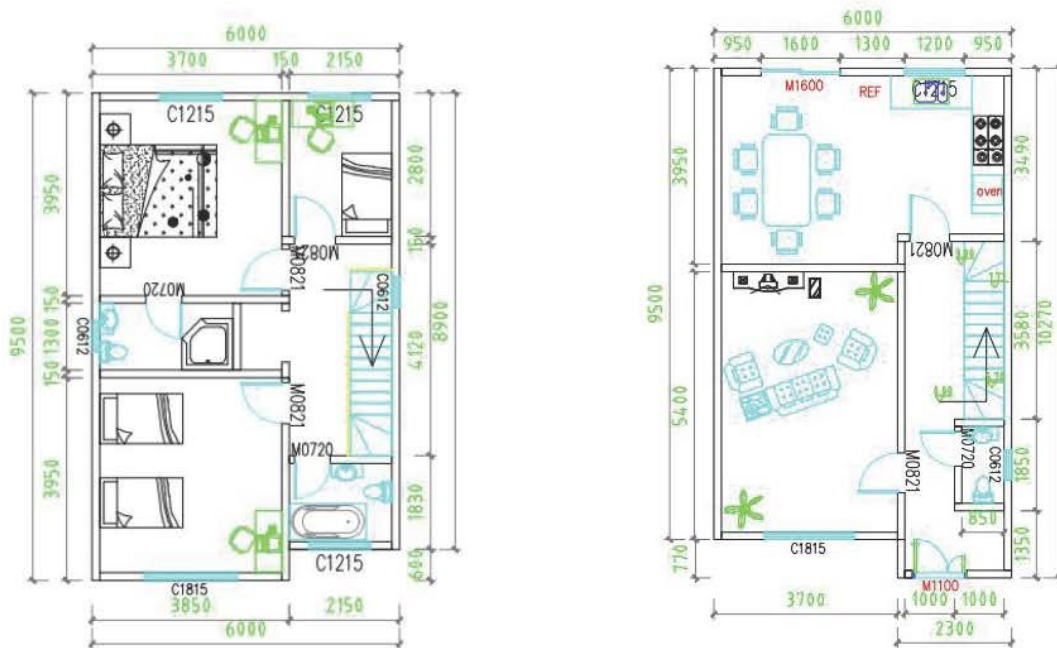

4 engineers were on the road of the installation of British villa





LIGHTSTEEL VILLA INSTALLATION





When the ground floor wall installation was finished, then we start to install the truss and floor.



Starting to install the wall of first floor.

LIGHTSTEEL VILLA INSTALLATION





The installation of the OSB board and waterproof material for the roof.



The guest use the brick-shaped cement fiber board for the first floor.





High density cement fiberboard and waterproof coating :



The installation of the thermal insulation board for the inside of the wall.



The installatio of the windows and doors.



The installation of the OSB board for interior wall.





Overall appearance





Indoor decoration





Other pictures:











