

ROME – TIBURTINA 1224

Office Building in Rome

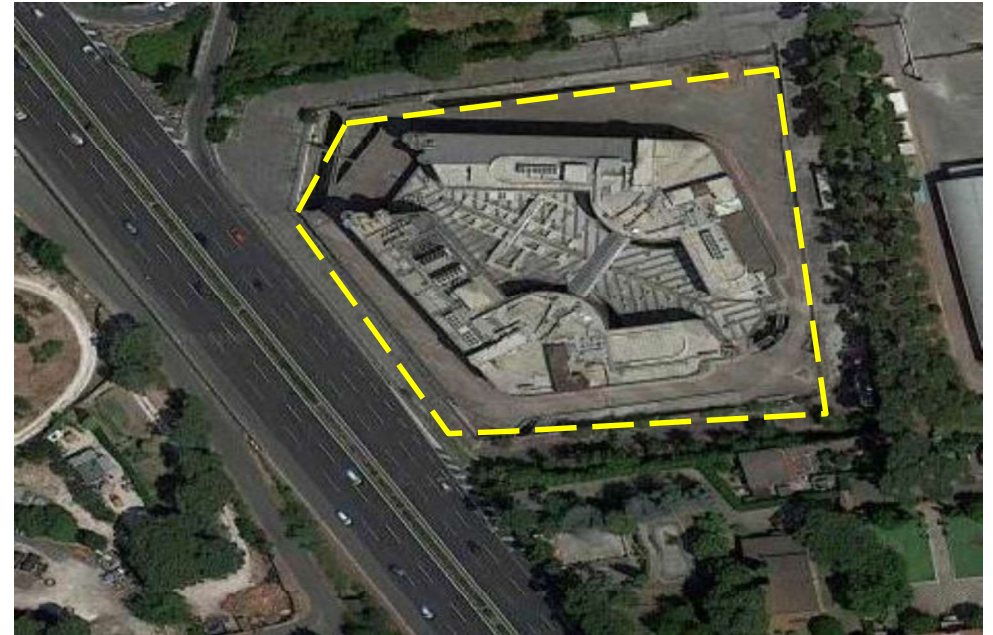

Asset Overview

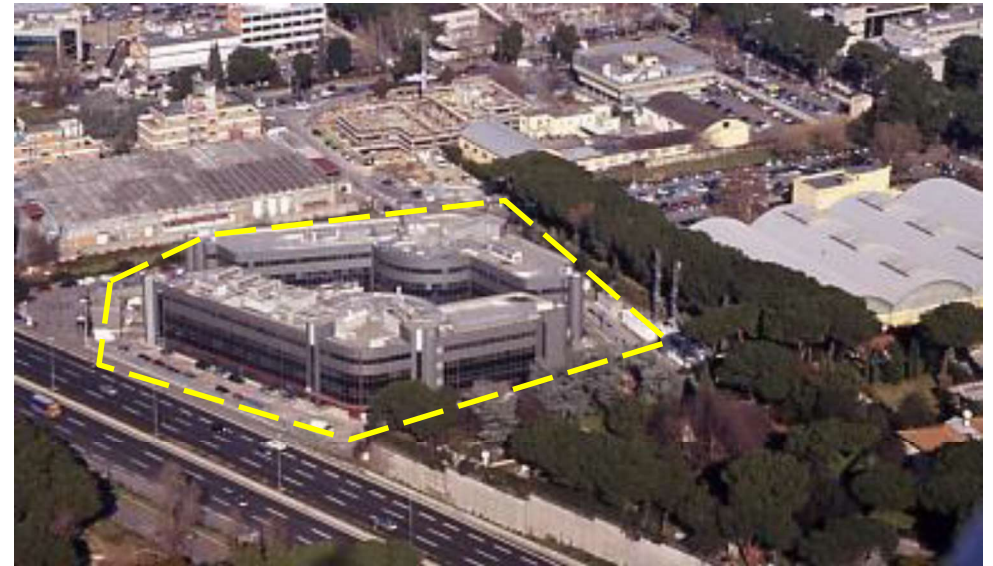
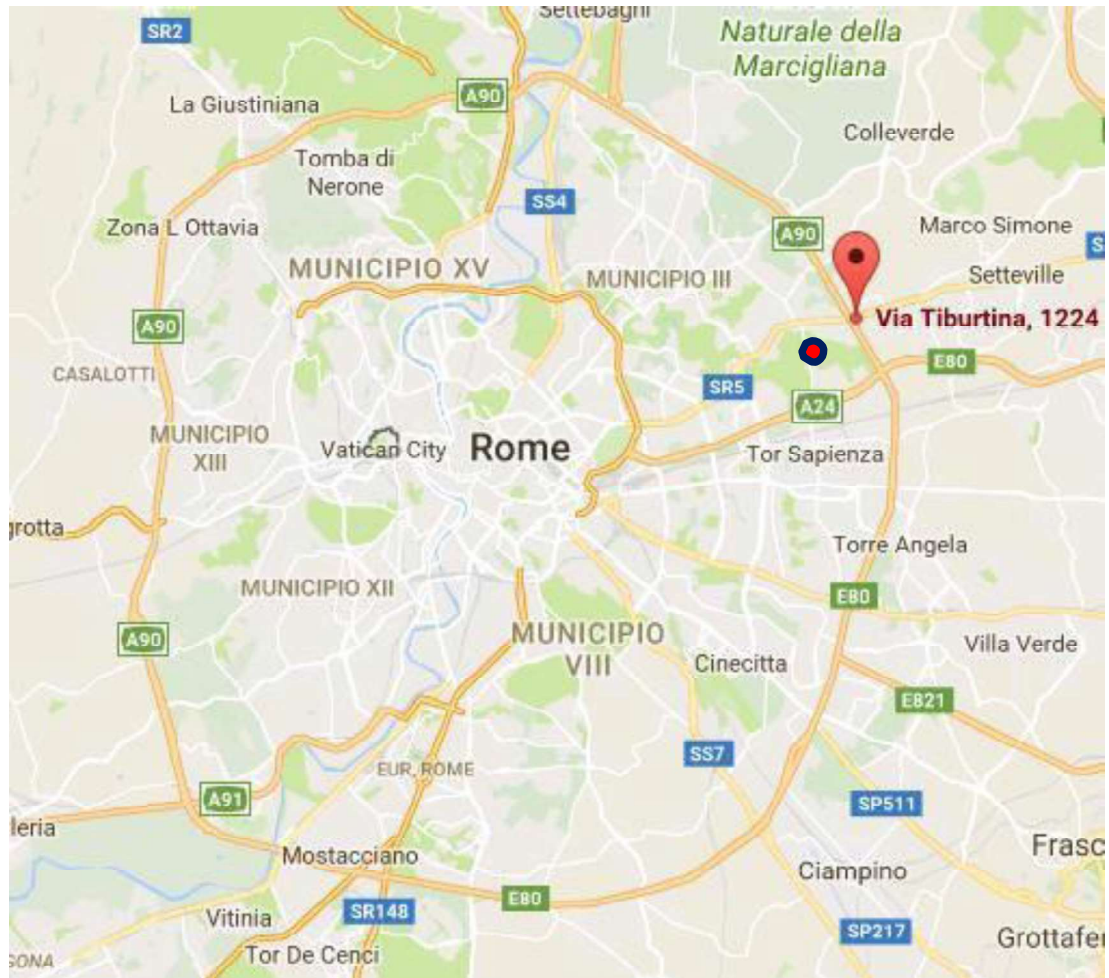

❑ **ADDRESS**

Via Tiburtina Km 12,280, n. 1224, Rome (Italy), Ring Road (G.R.A.) exit 13.

❑ **CITY POSITION**

The property is located to the eastern side of the city on G.R.A. Exit 13 overlooking Via Tiburtina.

❑ **ACCESS**

The building is easily accessible to downtown Rome via Tiburtina Road and the G.R.A., and it is in close proximity to major national highways (Milan/Rome, Rome/Naples and Rome/L'Aquila/Pescara).

❑ **AIRPORT**

Fiumicino is approximately 45 minutes away (40 Km).

Ciampino (intown-small airport) is approximately 15 minutes away (15 km).

❑ **STATION**

Termini is approximately 20 minutes away by car (12 km).



The building with glass façade in Alucobond aluminium panels contains **four floors above ground floor** and **two floors below** dedicated to the covered parking storages and technical areas.

- ❑ **YEAR OF CONSTRUCTION:** 1998;
 - ❑ **DESTINATION USE:** Office;
 - ❑ **CURRENT STATUS:** vacant;
 - ❑ **GLA:** 15,711 sqm;
 - ❑ **PARKING:** 466.
-

Floor areas:

Floor	Main use	GEA	GIA	Parking Places	
				Internal	External
Third Floor:	Offices	3.647	3.558		140
Second Floor:	Offices	3.647	3.558		
First Floor:	Offices	3.647	3.558		
Ground floor:	Offices, EDP, canteen	5.118	5.037		
Basement -1:	EDP, storage, tech. areas, parkings	10.073	9.455	185	
Basement -2:	Technical areas, parkings	10.073	8.932	143	
TOTAL		36.205	34.098	328	140

PROPERTY DESCRIPTION – FLOOR PLAN – SECOND BASAMENT



Second Basement

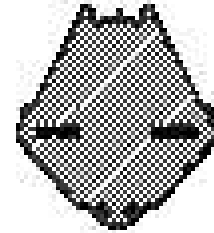
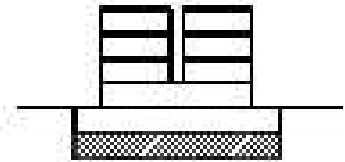

PROPERTY DESCRIPTION – FLOOR PLAN – FIRST BASEMENT

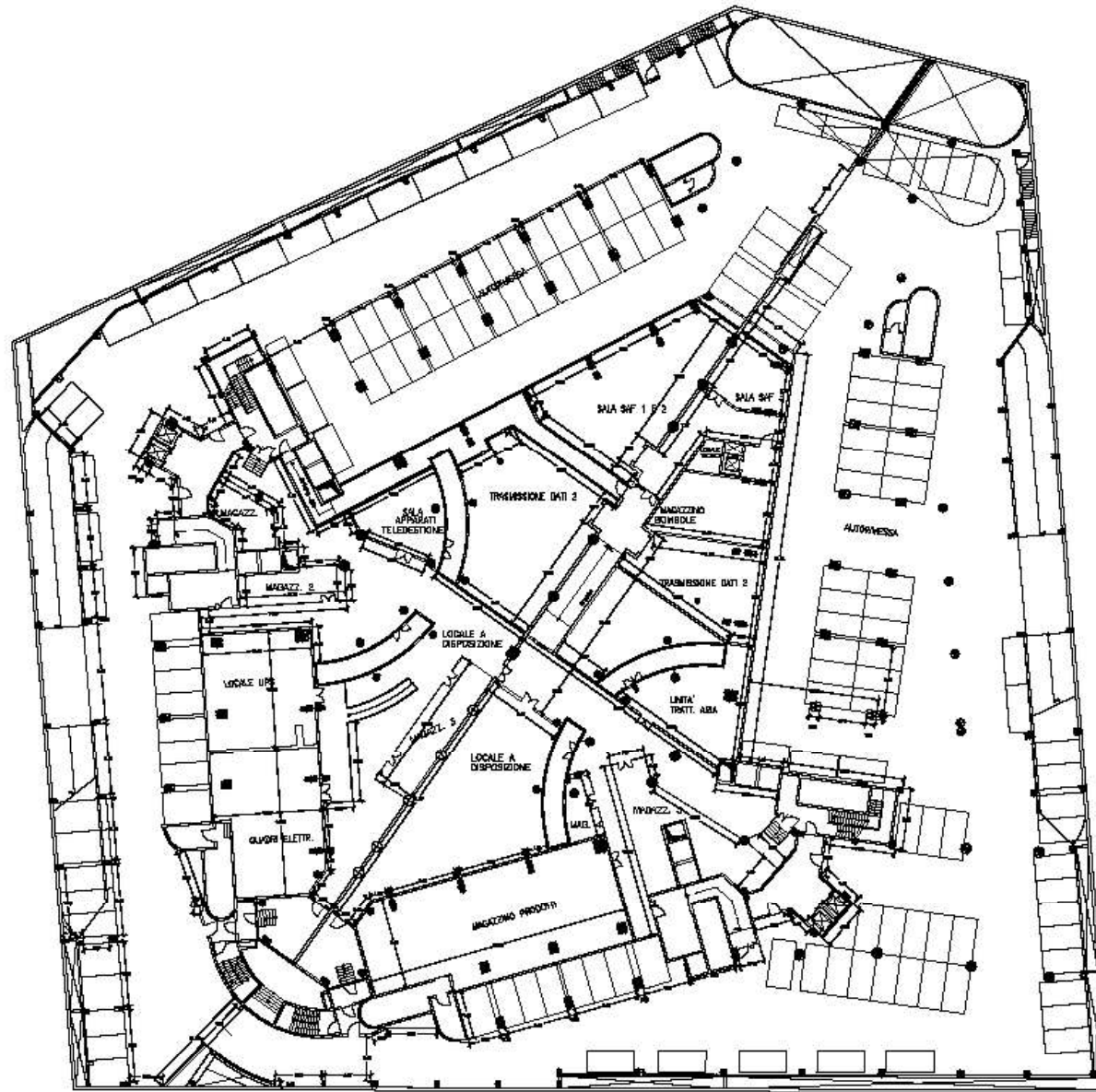

First Basement

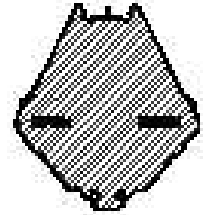
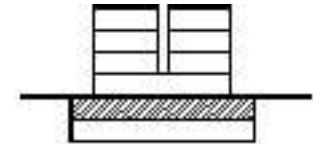

PROPERTY DESCRIPTION – FLOOR PLAN – GROUND FLOOR

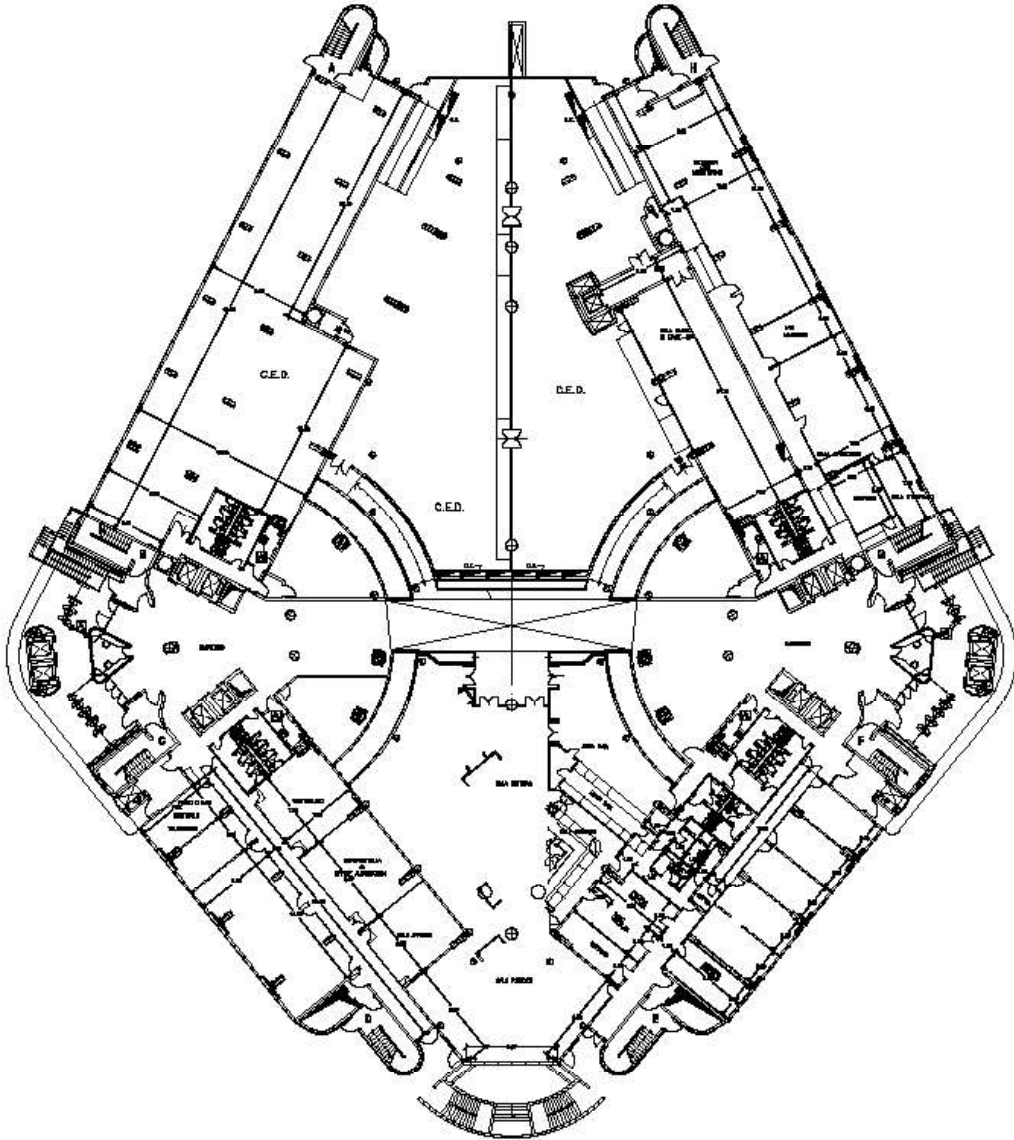

Ground Floor

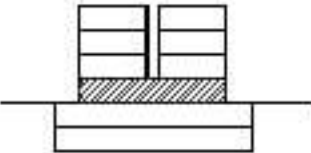

PROPERTY DESCRIPTION – FLOOR PLAN – FIRST FLOOR

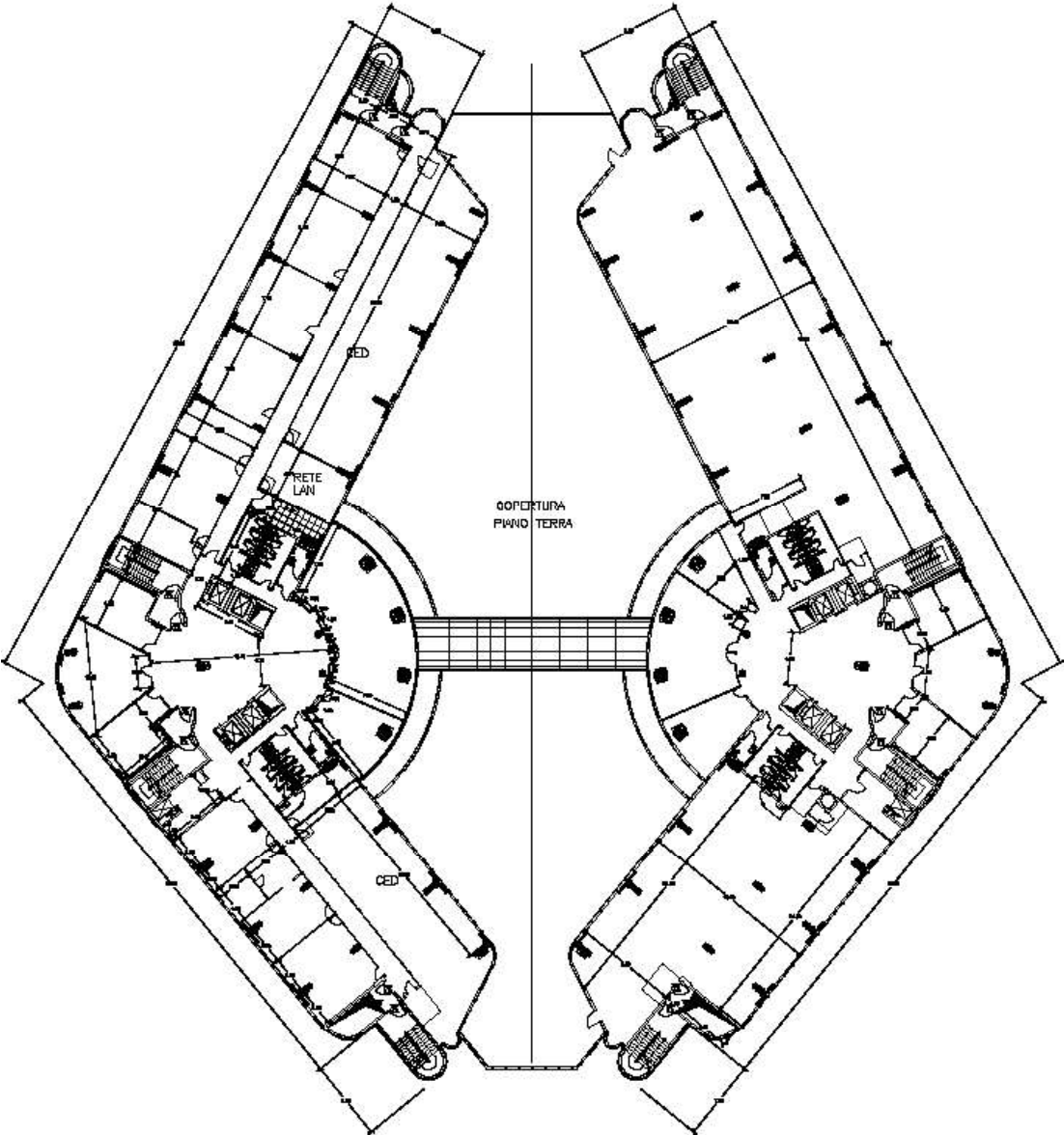

First Floor

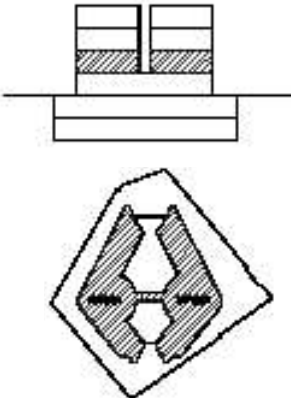

PROPERTY DESCRIPTION – FLOOR PLAN – SECOND FLOOR

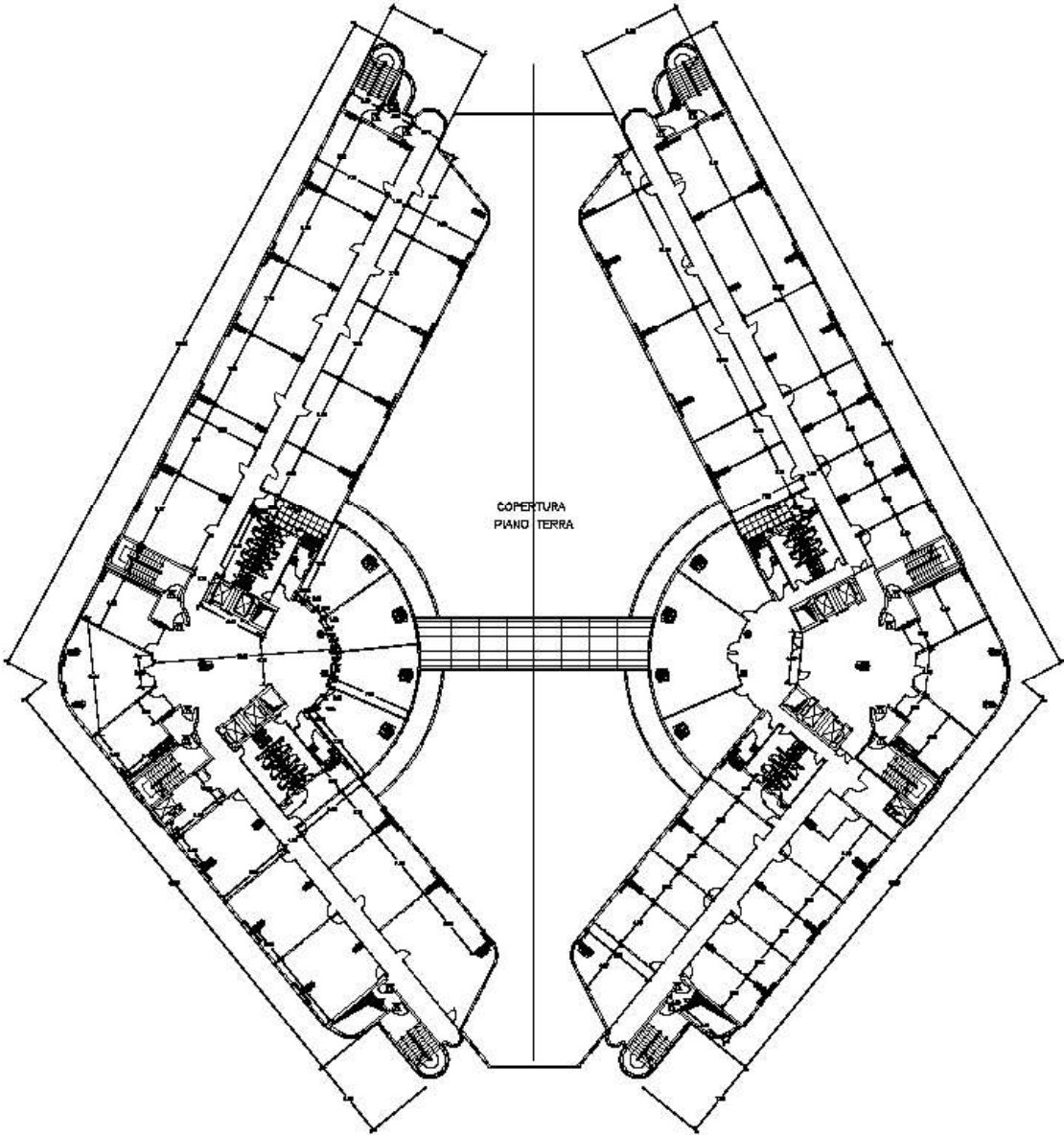

Second Floor

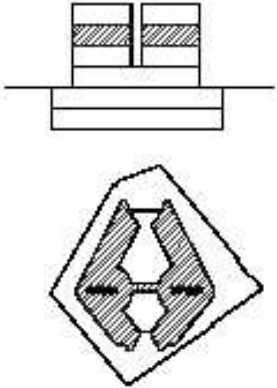

PROPERTY DESCRIPTION – FLOOR PLAN – THIRD FLOOR

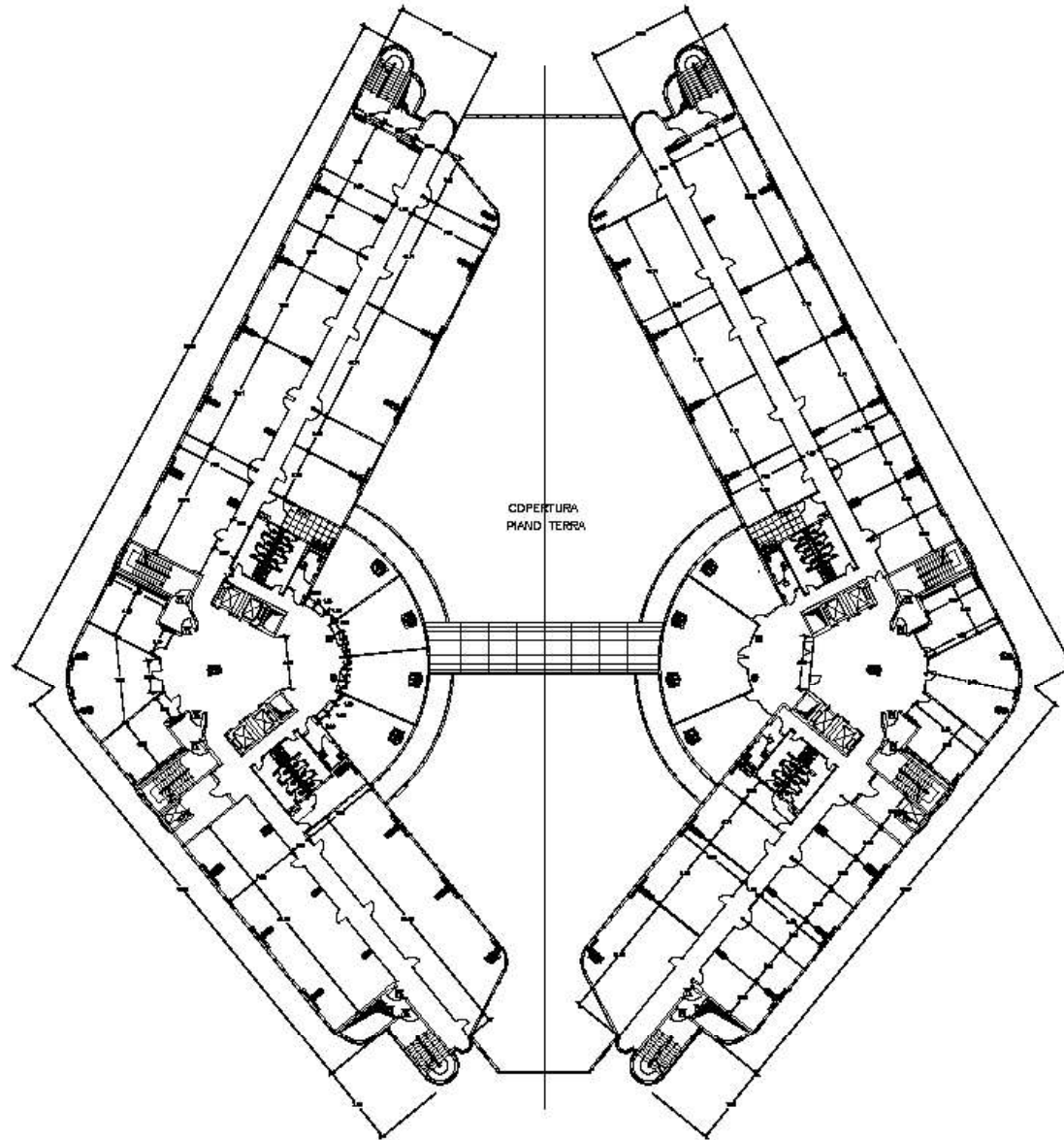

Third Floor

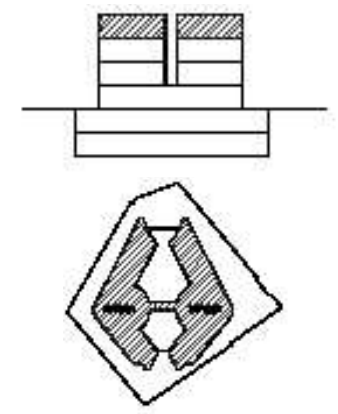

PROPERTY DESCRIPTION – VIEW FROM GRA



PROPERTY DESCRIPTION – VIEW FROM GRA









PROPERTY DESCRIPTION – SIDE ELEVATOR



