



PRODUCT PRESENTATION



PREFABRICATED HOUSE

Temporary Prefabricated Modular Sandwich Panel House
with Light Weight Steel Structure





ONLY 50 UNITS



The **Prefabricated House** uses a modular system of Light Weight color coated steel as its skeleton, with high performance thermal sandwich panels as roof and walls to insulate heat and sound for comfortable living within. It is a modern construction method, and has become more and more popular because of its advantages over other construction materials.



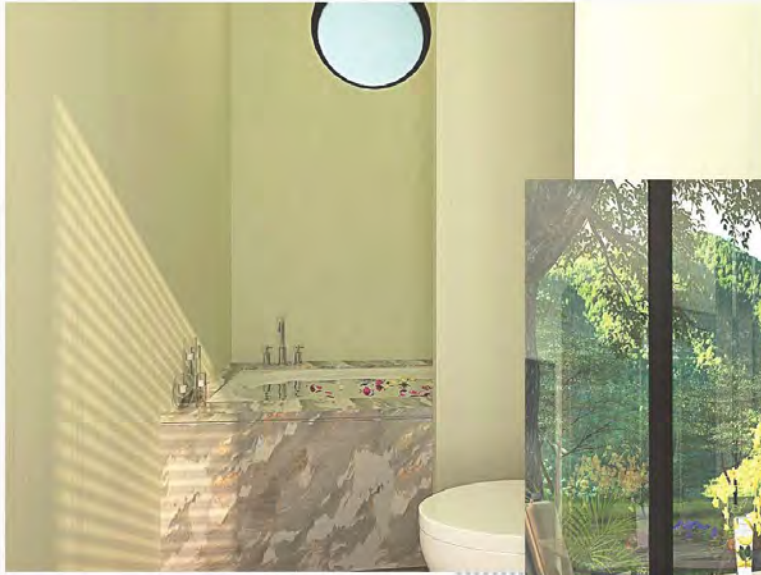



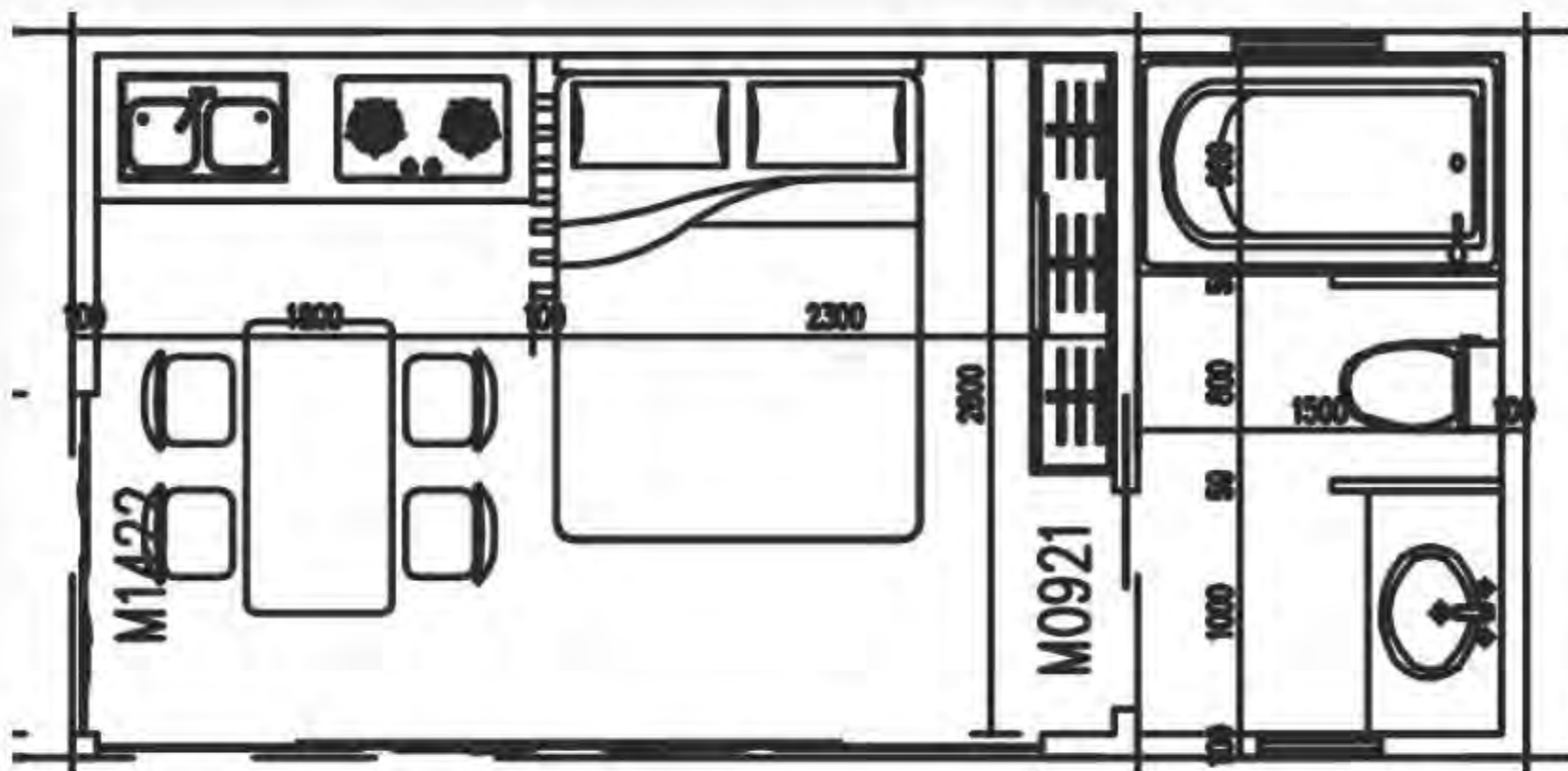

Size: 6m (L) x 3m(W) x 3m(H)

Main materials – roof, windows and doors, ceiling



- Wall :50MM EPS Steel Sandwich panel
Heat insulation



- Wall :50MM EPS Steel Corrugated Sandwich panel
Heat insulation



1000×1000 PVC Sliding Window



Steel door



Gypsum board ceiling

Reduced Manpower

Less workers are required to setup the prefab house due to its modular system

Cost Effective

Savings from Material, Machineries, Manpower, Reusability

Practical and Convenient

Easy to transport, dissembled packing and loaded by truck or container

Faster Completion

Easily installed prefabricated construction parts ensure faster installation time

Short production time

25 days of production time from the receipt of order confirmation



Aesthetic

Elegant and sleek in design, modern and minimalistic, 12 different colors

Long Life span

8– 15 years for temporary structures

Reusable

Capital expenditure has residual value

Energy saving and Eco-friendly

All parts are produced in factory, causing less damage to environment, producing less waste; repeatedly use

Versatile

Applicable on slope, hill, grassland, desert, riverside, etc.



Water proof

Sandwich panels resistant to water leakage

High impact resistant

Solid and strong double layer sandwich panel surrounded by steel frame structure

Fire resistant

Acoustic and thermal insulation

Sound proofed up to 45db, with rockwool producing thermal insulation for occupant's comfort

Stable and Safe

Resistant to earthquake (level 8) and typhoon (level 10); fastened roof and wire ropes anchoring in the ground





TOTAL PACKAGE