



TRUE BLUE CABIN

CONVENIENT, FAST AND WIDELY USED



Mode of transport

2. Assemble. When the whole house is shipped in assembled, This way it can be used immediately when it arrives in your local area. Usually a 20ft container can hold 1 set cabins(5.8m) without furniture. And a 40ft container can hold 1-2set cabins without furniture(11.6m*1 or 5.8m*2 or 8.5m*1).

Standard size: 5.8*2.25*2.25m, 8.5*2.25*2.45, 11.6*2.25*2.45m



What projects are there for assembly: 1) electrician? 2) water supply? 3) sewerage 4) heating and ventilation?

Electrical appliances and plumbing can be pre-installed in the house, and we use electrical appliances of international standards, which also comply with Russia. We will use air conditioning for heating. After the order is confirmed, we will provide the customer with circuit layout diagrams, water supply, and drainage layout diagrams, structural diagrams, etc.



What projects are there for assembly: 1) electrician? 2) water supply? 3) sewerage 4) heating and ventilation?

3. The plumbing fixtures are also international standards, common to all countries. If you have special requirements, we can also replace them for you. These are the plans just for your reference.

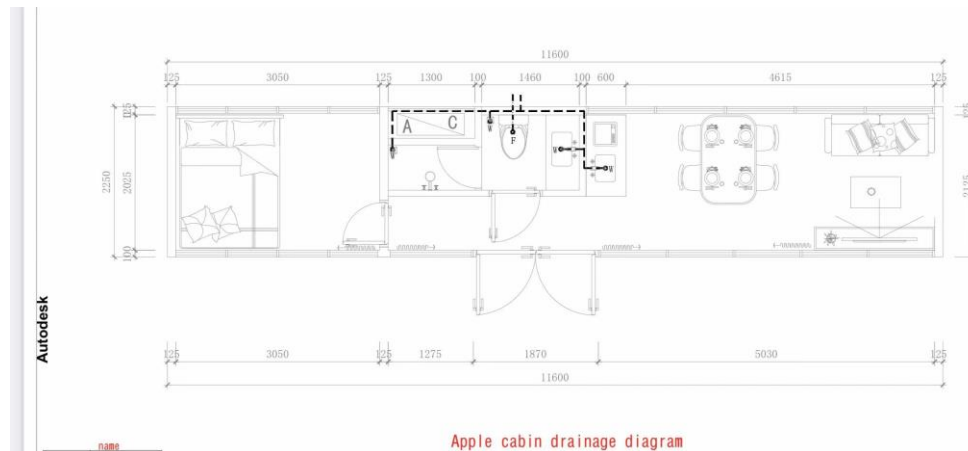
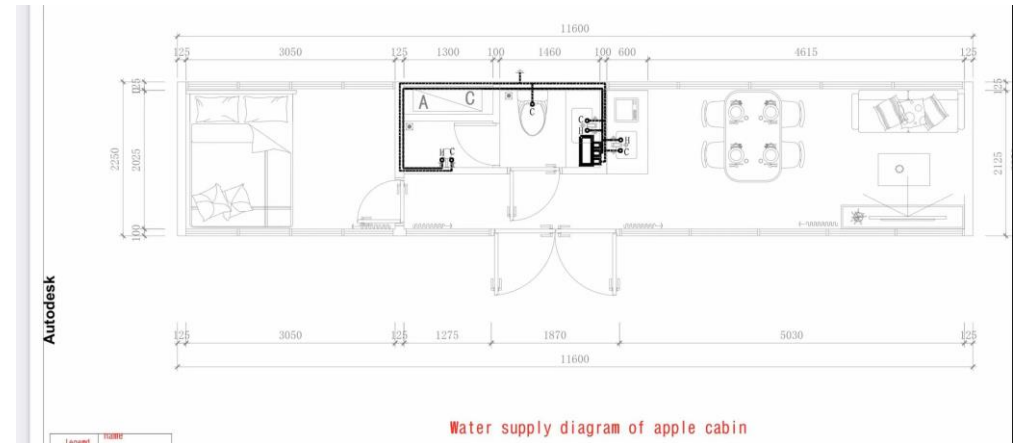

What spare parts do we need to have on-site?

Ordinary installation tools are sufficient. You just need to build a concrete foundation or a stable and firm ground locally.



how the pods would need to be lifted and anchored

4. Generally speaking, because our pod weighs 2-3 tons, it generally does not need to be fixed on the ground. Just place it on a stable, firm surface. If it is two layers stacked together, there will be support feet. We will install hoisting rings at the top for easy to use hoisting machine.



12、 What are the product certificates?

We have ISO and CE certifications, can be imported into USA , Australia and Europe etc.

