

Aircraft

Aircraft Main Data		Ownership		Dates		Values	
Registration	---	Manufacturer	202046	Mfg. Date	24.Apr.2012	Daily Hours	16:00
Description	AIRBUS A330-202 -		---	Del. Date	29.May.2012	Daily Cycles	2.00
AC-Type	331		---	Exp. Date	09.Dec.2027	Current TAH	38.718:06
Subtype	331N	Maint. Provider	AZA	Cert. Issue Date	17.May.2019	Current TAC	4'454
Serial No.	1313			Cert. Exp. Date	28.May.2022	Last Update	16.Aug.2021



Instant Info: Aircraft Details

AZA
09:46

14.Oct.2021
Page 1

State	Dep. Date	Arr. Date	A/C	Carrier	Flight	Type of Flight	Flight Log	# of Day	Hours	Cycles	TAH	TAC	Dep.	Arr.	Dep. Time	Arr. Time
Scheduled	16.Aug.2021	16.Aug.2021		ITY	ITY1	P		1	00:53	1	38718:06	4'454	FCO	FCO	14:30	16:00
Actual	16.Aug.2021	16.Aug.2021		ITY	ITY1	P	1073867010	1	00:53	1	38718:06	4'454	FCO	FCO	14:25	15:18
Future																

Major Rotables (parts with special code 'ENGINE','PROP','APU','LDG'):

Type	Partnumber	Serialnumber	Description	Pos	Inst.-Date	TSN	CSN	TBI	CBI	Dim	Togo	Expected	Planned	Workorder
LDG	10-210501-003	12MDG2296	MAIN STRUT & DRESSG, LH E-MLG	LH MLG	24.Apr.2012	38718:06	4'454	38718:06	4'454	D	227	29.May.2022		106192699
LDG	10-210601-003	12MDG2297	MAIN STRUT & DRESSG, RH E-MLG	RH MLG	24.Apr.2012	38718:06	4'454	38718:06	4'454	D	227	29.May.2022		102927241
LDG	10-211901-001	12MDG2298	SIDE STAY ASSY	LH MLG	24.Apr.2012	38718:06	4'454	38718:06	4'454	D	227	29.May.2022		106192769
LDG	10-212001-001	12MDG2299	SIDE STAY ASSY	RH MLG	24.Apr.2012	38718:06	4'454	38718:06	4'454	D	227	29.May.2022		106192771
APU	3800454-6	P-1401	APU GTCP 331-350C A330	APU	04.Aug.2021	37768:16	4'357	01:20	2					
ENGINE	CF6-80E1A4B	811604	CF6-80E1A4B GE ENGINE	LH ENG	04.Aug.2021	36000:28	4'158	01:20	2	H	370:11	06.Nov.2021		108806364
ENGINE	CF6-80E1A4B	811605	CF6-80E1A4B GE ENGINE	RH ENG	04.Aug.2021	35830:17	4'124	01:20	2	C	60	13.Nov.2021		108792722
LDG	D23444000	12B10150	UPPER ARM DRAG STAY ASSY, NLG	NLG	24.Apr.2012	38718:06	4'454	38718:06	4'454	D	227	29.May.2022		102147223
LDG	D23581100-20	12B10152	NLG - LEG ASSY + DRESSINGS	NLG	24.Apr.2012	38718:06	4'454	38718:06	4'454	D	227	29.May.2022		102147221



Check planning (letter checks plus 3 month forecast):

Type	Description	Dim	Togo	Expected	Planned	Workorder
WEEKLY	WEEKLY/W108751458 /WEEKLY A330	D	-53	21.Aug.2021		108751458
A12280561	A12280561/W108378816 /2 MTH - DRAIN TRIM TANK (ETOPS)	D	-36	07.Sep.2021		108378816
A26991961	A26991961/18 MTH/7500 FLH - ITEMS	D	-28	15.Sep.2021		
SWITCH PARK<1TO>1MT	SWITCH PARK<1TO>1MT/W108911749 /PARKING SWITCH FROM UPTO 1MT TO MORE	D	-27	16.Sep.2021	16.Sep.2021	108911749

PRE MOD. CONFIGURATION ref. AIRBUS dwg 330-25.28433-01T EFF. 1123, 1135

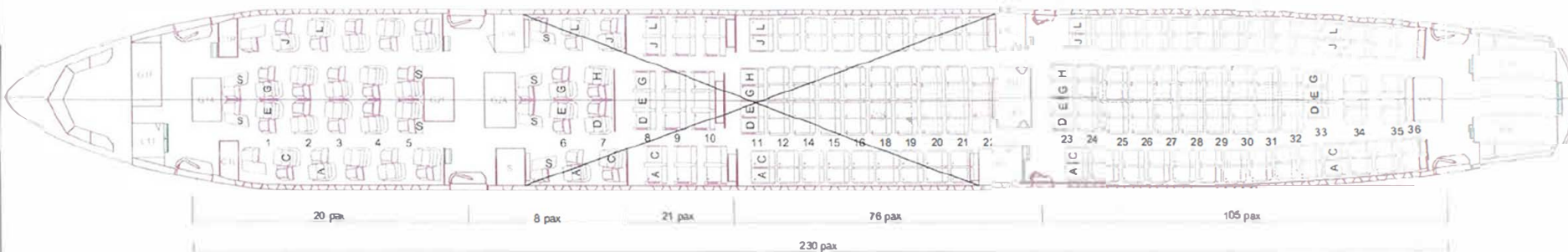

PRE MOD. COFIGURATION ref. AIRBUS dwg 330-25.33455-01C EFF. 1218, 1225, 1252, 1283, 1308, 1327, 1354

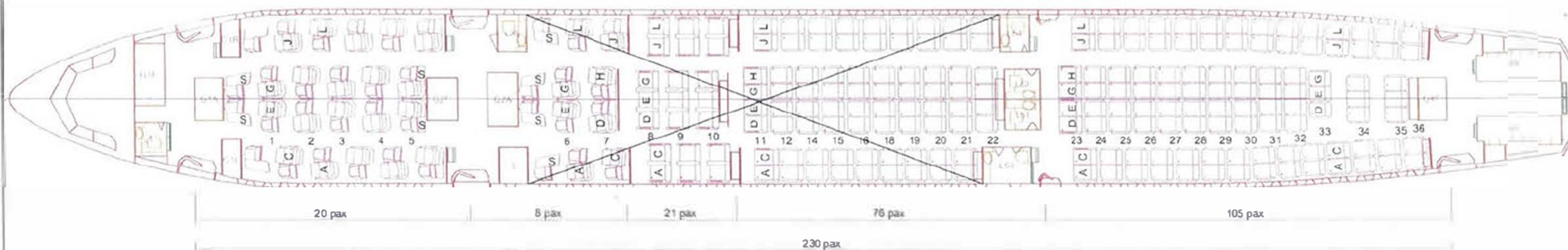

POST MOD. CONFIGURATION
SECTION DOOR 2 - DOOR 3

EFF.1123, 1135, 1218, 1225, 1252,
1283, 1308, . 1327, 1354

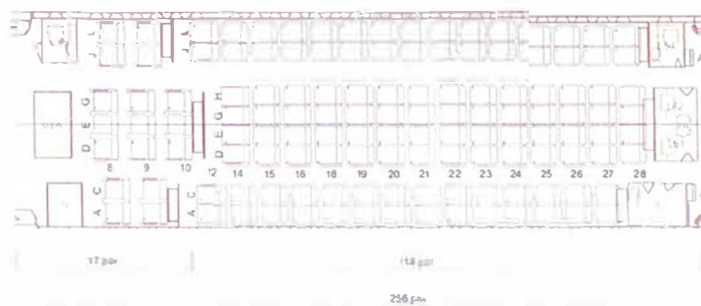

COMPAGNY ABLRIAL ANB		DWG N°	ICO-13-003	Rev.	00
		Date	20:09-2013	Sheet	1 / 2
Utilisat°	ICO	Rep DWG	ICO-13-007	Modé	A-330
				Statut	NONE
A330 - LOPA 256 psg		Drawn	<i>Fede Mawer</i>		
		Designer	<i>[Signature]</i>		
		COFA	<i>[Signature]</i>		

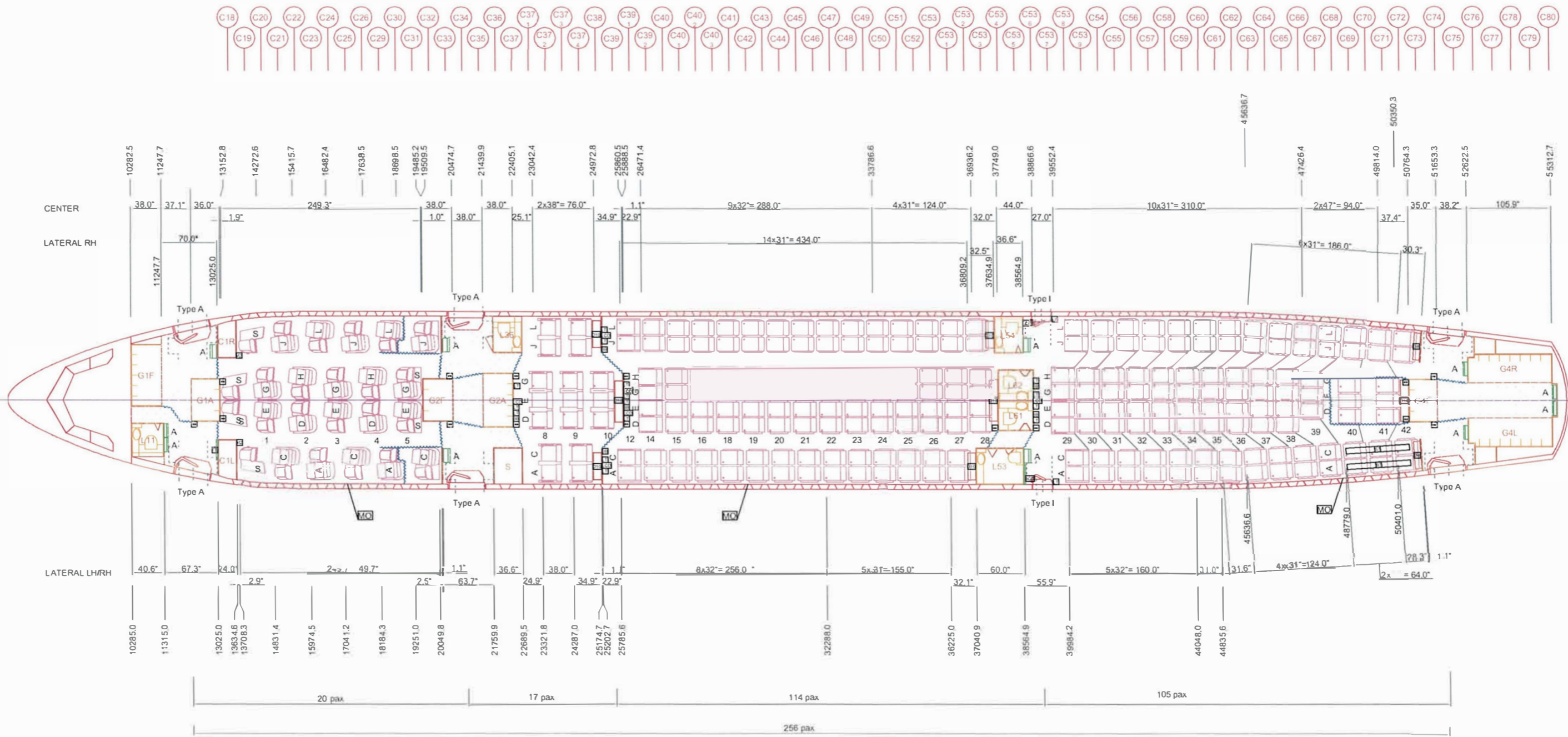

- BABY BASSINET INNOVINT
- CURTAIN TIE-BACKS
- FOLDING TABLE
- LCD SCREEN
- LITERATURE POCKETS
- DOUBLE SLOT MAGAZINE RACK
- MEDICAL OUTLET
- STREET LOCATION
- 8 INCHES DOGHOUSE WITH DRAWER
- 10 INCHES DOGHOUSE WITH DRAWER
- IN ARMREST TABLE
- NO TEXTILE FLOOR

COMPAGNIA AEREA ITALIANA		DWG N°	Rev
		ICO-13-003	00
Ufficio ICO		Date	Sheet of
		20:09:2013	2 of 2
Top DWG	Model	Scale	
ICO-13-007	A-330	NONE	

QUESTO DISEGNO È DI PROPRIETÀ DELL'ALITALIA E NON PUÒ ESSERE RIPRODOTTO SENZA LA SUA AUTORIZZAZIONE.
This drawing cannot be reproduced in any form without approval of ALITALIA.

STC STATUS

AZA

14.Oct.2021

06:01

Page 1/2

Document-Number	Type	Rev	Compliance	A/C	Subject	Status
10037167	STC	00	Mandatory	A/C	PANASONIC GLOBAL COMMUNICATION SYSTEM - ANTENNA INSTALLATION	Closed 13.May.2016 W/O:101779913
Complete document sign-up hierarchy						
10037167/STC Rev.00					PANASONIC GLOBAL COMMUNICATION SYSTEM - ANTENNA INSTALLATION	Closed 13.May.2016 W/O:101779913
> ST02884NY/STC Rev.00					INSTALLATION OR REMOVAL OF A PANASONIC GLOBAL COMMUNICATION SUITE (GCS) ANTENNA	Closed 13.May.2016 W/O:101779913
>> EOC-331-53-00008-R01/EOC* Rev.01					INSTALLATION - PANASONIC GCS ANTENNA, A330-200	Closed 13.May.2016 W/O:101779913
Replacement Information						
This Document SUPERSEDES					EOC-331-53-00008-R00/EOC Rev.00	
Perf Dim1 (D)	Perf Dim2	Perf Dim3	W/O	Remarks		
13.May.2016	18783:32/H	2'188/C	101779913	Was due at: 24.May.2016 PerfRev.: '01'		
ST02884NY	STC	00	Mandatory	A/C	INSTALLATION OR REMOVAL OF A PANASONIC GLOBAL COMMUNICATION SUITE (GCS) ANTENNA	Closed 13.May.2016 W/O:101779913
Complete document sign-up hierarchy						
ST02884NY/STC Rev.00					INSTALLATION OR REMOVAL OF A PANASONIC GLOBAL COMMUNICATION SUITE (GCS) ANTENNA	Closed 13.May.2016 W/O:101779913
> EOC-331-53-00008-R01/EOC* Rev.01					INSTALLATION - PANASONIC GCS ANTENNA, A330-200	Closed 13.May.2016 W/O:101779913
Replacement Information						
This Document SUPERSEDES					EOC-331-53-00008-R00/EOC Rev.00	
Perf Dim1 (D)	Perf Dim2	Perf Dim3	W/O	Remarks		
13.May.2016	18783:32/H	2'188/C	101779913	Was due at: 24.May.2016 PerfRev.: '01'		
STC A330 ST02926NY	STC	00	Mandatory	A/C	STC 2 CABIN MOD FOR CONNECTIVITY	Closed 12.May.2016 W/O:101793425
Complete document sign-up hierarchy						

STC STATUS

ITA_VC

14.Oct.2021

06:01

Page 2/2

Document-Number	Type	Rev	Compliance	A/C	Subject	Status
STC A330 ST02926NY/STC Rev.00					STC 2 CABIN MOD FOR CONNECTIVITY	Closed 12.May.2016 W/O:101793425
> EOC-331-23-00004-R02/EOC* Rev.02					INSTALLATION OF THE GCS SYSTEM	Closed 12.May.2016 W/O:101793425
Replacement Information						
This Document SUPERSEDES					EOC-331-23-00004-R01/EOC Rev.01	
Perf Dim1 (D)	Perf Dim2	Perf Dim3	W/O	Remarks		
12.May.2016	18783:32/H	2'188/C	101793425	Was due at: 24.May.2016 PerfRev.: '02'		
STC A330 ST0632-01	STC	00		A/C	STC A330 IPAD MOUNTING A330 TUTTI	Closed 12.May.2016 W/O:101924580
Complete document sign-up hierarchy						
STC A330 ST0632-01/STC Rev.00					STC A330 IPAD MOUNTING A330 TUTTI	Closed 12.May.2016 W/O:101924580
> 0632-01-AL-3101/SB Rev.01					STC 0632-01 TABLET PROVISION ON AIRBUS A330	Closed 12.May.2016 W/O:101924580
>> EOC-331-23-00005-R00/EOC* Rev.00					TABLET PROVISION ON AIRBUS A330	Superseded
Replacement Information						
This Document has been SUPERSEDED BY					EOC-331-23-00005-R01/EOC Rev.01	
Reason for this Status						
Manually deassigned after Document Cancelled or Superseded						
>> EOC-331-23-00005-R01/EOC* Rev.01					A330: PERSONAL TABLET COMPUTER INTERFACE PROVISION	Closed 12.May.2016 W/O:101924580
Replacement Information						
This Document SUPERSEDES					EOC-331-23-00005-R00/EOC Rev.00	
Perf Dim1 (D)	Perf Dim2	Perf Dim3	W/O	Remarks		
12.May.2016	18783:32/H	2'188/C	101924580	Was due at: 20.Apr.2016 PerfRev.: '01'		

DOA STATUS

ITA_VC

14.Oct.2021

08:04

Page 1/11

Document-Number	Type	Rev	Compliance	A/C	Subject	Status										
2010-0019	DOA	05	Recommended	A/C	A330-202E: INTERIORS STANDARDIZATION	Open										
					<table border="1" style="width: 100%; border-collapse: collapse;"> <thead> <tr> <th style="width: 15%;">Due Dim1 (D)</th> <th style="width: 15%;">Due Dim2</th> <th style="width: 15%;">Due Dim3</th> <th style="width: 15%;">New W/O</th> <th style="width: 40%;">Time-Requirement of Document</th> </tr> </thead> <tbody> <tr> <td></td> <td></td> <td></td> <td></td> <td>No limit</td> </tr> </tbody> </table>	Due Dim1 (D)	Due Dim2	Due Dim3	New W/O	Time-Requirement of Document					No limit	
Due Dim1 (D)	Due Dim2	Due Dim3	New W/O	Time-Requirement of Document												
				No limit												
2013-0022	DOA	02	Recommended	A/C	A330 - CABIN LAYOUT FROM 230 TO 256 PASSENGERS	Closed 13.May.2014 W/O:101255601										
					<table border="1" style="width: 100%; border-collapse: collapse;"> <thead> <tr> <th style="width: 15%;">Perf Dim1 (D)</th> <th style="width: 15%;">Perf Dim2</th> <th style="width: 15%;">Perf Dim3</th> <th style="width: 15%;">W/O</th> <th style="width: 40%;">Remarks</th> </tr> </thead> <tbody> <tr> <td>13.May.2014</td> <td>9500:00/H</td> <td>1'101/C</td> <td></td> <td>Was due at: 31.May.2014 PerfRev.: '01' / Ref-Doc : 101255601</td> </tr> </tbody> </table>	Perf Dim1 (D)	Perf Dim2	Perf Dim3	W/O	Remarks	13.May.2014	9500:00/H	1'101/C		Was due at: 31.May.2014 PerfRev.: '01' / Ref-Doc : 101255601	
Perf Dim1 (D)	Perf Dim2	Perf Dim3	W/O	Remarks												
13.May.2014	9500:00/H	1'101/C		Was due at: 31.May.2014 PerfRev.: '01' / Ref-Doc : 101255601												
Complete document sign-up hierarchy																
2013-0022/DOA* Rev.02					A330 - CABIN LAYOUT FROM 230 TO 256 PASSENGERS	Closed 13.May.2014 W/O:101255601										
					<table border="1" style="width: 100%; border-collapse: collapse;"> <thead> <tr> <th style="width: 15%;">Perf Dim1 (D)</th> <th style="width: 15%;">Perf Dim2</th> <th style="width: 15%;">Perf Dim3</th> <th style="width: 15%;">W/O</th> <th style="width: 40%;">Remarks</th> </tr> </thead> <tbody> <tr> <td>13.May.2014</td> <td>9500:00/H</td> <td>1'101/C</td> <td></td> <td>Was due at: 31.May.2014 PerfRev.: '01' / Ref-Doc : 101255601</td> </tr> </tbody> </table>	Perf Dim1 (D)	Perf Dim2	Perf Dim3	W/O	Remarks	13.May.2014	9500:00/H	1'101/C		Was due at: 31.May.2014 PerfRev.: '01' / Ref-Doc : 101255601	
Perf Dim1 (D)	Perf Dim2	Perf Dim3	W/O	Remarks												
13.May.2014	9500:00/H	1'101/C		Was due at: 31.May.2014 PerfRev.: '01' / Ref-Doc : 101255601												
> EOC-331-25-00016-R01/EOC* Rev.01					CABIN INTERIOR MODIFICATION FROM 230 TO 256 PASSENGERS	Closed 13.May.2014 W/O:101255601										
					Replacement Information											
					This Document SUPERSEDES	EOC-331-25-00016-R00/EOC Rev.00										
					<table border="1" style="width: 100%; border-collapse: collapse;"> <thead> <tr> <th style="width: 15%;">Perf Dim1 (D)</th> <th style="width: 15%;">Perf Dim2</th> <th style="width: 15%;">Perf Dim3</th> <th style="width: 15%;">W/O</th> <th style="width: 40%;">Remarks</th> </tr> </thead> <tbody> <tr> <td>13.May.2014</td> <td>9500:00/H</td> <td>1'101/C</td> <td>101255601</td> <td>Was due at: 31.May.2014 PerfRev.: '01'</td> </tr> </tbody> </table>	Perf Dim1 (D)	Perf Dim2	Perf Dim3	W/O	Remarks	13.May.2014	9500:00/H	1'101/C	101255601	Was due at: 31.May.2014 PerfRev.: '01'	
Perf Dim1 (D)	Perf Dim2	Perf Dim3	W/O	Remarks												
13.May.2014	9500:00/H	1'101/C	101255601	Was due at: 31.May.2014 PerfRev.: '01'												
2013-0030	DOA	00	Recommended	A/C	A330 ALTERNATE PARTS: CURTAINS	Superseded (Closed 26.May.2015 / Special Text: DOCUMENT ISSUED: ST A13-014_R00 , IPC TR-25-010ALI)										
					Replacement Information											
					This Document has been SUPERSEDED BY	2013-0030/DOA Rev.01										
					<table border="1" style="width: 100%; border-collapse: collapse;"> <thead> <tr> <th style="width: 15%;">Perf Dim1 (D)</th> <th style="width: 15%;">Perf Dim2</th> <th style="width: 15%;">Perf Dim3</th> <th style="width: 15%;">W/O</th> <th style="width: 40%;">Remarks</th> </tr> </thead> <tbody> <tr> <td></td> <td></td> <td></td> <td></td> <td></td> </tr> </tbody> </table>	Perf Dim1 (D)	Perf Dim2	Perf Dim3	W/O	Remarks						
Perf Dim1 (D)	Perf Dim2	Perf Dim3	W/O	Remarks												

DOA STATUS

ITA_VC
08:04

14.Oct.2021
Page 2/11

Documents

Document-Number	Type	Rev	Compliance	A/C	Subject					Status	
					26.May.2015	14334:00/H	1'689/C			Was due at: No limit PerfRev.: '00' / Reason: DOCUMENT ISSUED: ST A13-014_R00 , IPC TR-25-010ALI / Return Information: DOCUMENT ISSUED: ST A13-014_R00 , IPC TR-25-010ALI	
Reason for this Status											
DOCUMENT ISSUED: ST A13-014_R00 , IPC TR-25-010ALI											
2013-0030	DOA	01	Recommended	A/C	A330 CURTAINS: MANUFACTURING AND INSTALLATION					Superseded (Closed 12.May.2016 W/O:101762845)	
Replacement Information											
					This Document SUPERSEDES			2013-0030/DOA Rev.00			
					This Document has been SUPERSEDED BY			2013-0030/DOA Rev.02			
Complete document sign-up hierarchy											
2013-0030/DOA* Rev.01					A330 CURTAINS: MANUFACTURING AND INSTALLATION					Closed 12.May.2016 W/O:101762845	
Replacement Information											
					This Document SUPERSEDES			2013-0030/DOA Rev.00			
					This Document has been SUPERSEDED BY			2013-0030/DOA Rev.02			
> EOC-331-25-00050-R00/EOC* Rev.00					A330 CREW REST CURTAIN INSTALLATION					Closed 12.May.2016 W/O:101762845	
Perf Dim1 (D) Perf Dim2 Perf Dim3 W/O Remarks											
					12.May.2016	18783:32/H	2'188/C	101762845	Was due at: 20.Apr.2016 PerfRev.: '00'		
2014-0007	DOA	04		A/C	A330E MANUFACTURING AND INSTALLATION OF CARPETS					Superseded (Closed 12.May.2016 W/O:101739863)	
Replacement Information											
					This Document SUPERSEDES			2014-0007/DOA Rev.03			
					This Document has been SUPERSEDED BY			2014-0007/DOA Rev.05			
Complete document sign-up hierarchy											

DOA STATUS

ITA_VC
08:04

14.Oct.2021
Page 3/11

Document-Number	Type	Rev	Compliance	A/C	Subject	Status
2014-0007/DOA Rev.04					A330E MANUFACTURING AND INSTALLATION OF CARPETS	Closed 12.May.2016 W/O:101739863
Replacement Information						
This Document SUPERSEDES					2014-0007/DOA Rev.03	
This Document has been SUPERSEDED BY					2014-0007/DOA Rev.05	
> EOC-331-25-00037-R00/EOC* Rev.00					A330 NEW CARPET INSTALLATION	Closed 12.May.2016 W/O:101739863
Perf Dim1 (D) Perf Dim2 Perf Dim3 W/O Remarks						
12.May.2016 18783:32/H 2'188/C 101739863 Was due at: 20.Apr.2016 PerfRev.: '00'						
2014-0007	DOA	00	Recommended	A/C	A330E MANUFACTURING AND INSTALLATION OF CARPETS FOR PASSENGER CABIN	Superseded (Closed 25.May.2015 / Special Text: ref. to Dwg_ICO_14-001_R00 and ST-A10-025_R02)
Replacement Information						
This Document has been SUPERSEDED BY					2014-0007/DOA Rev.01	
Perf Dim1 (D) Perf Dim2 Perf Dim3 W/O Remarks						
Was due at: No limit PerfRev.: '00' / Reason: ref. to Dwg_ICO_14-001_R00 and ST-A10-025_R02 / Return Information: ref. to Dwg_ICO_14-001_R00 and ST-A10-025_R02						
Reason for this Status						
ref. to Dwg_ICO_14-001_R00 and ST-A10-025_R02						
2014-0007	DOA	03		A/C	A330E MANUFACTURING AND INSTALLATION OF CARPETS	Superseded (Closed 12.May.2016 W/O:101739863)
Replacement Information						
This Document SUPERSEDES					2014-0007/DOA Rev.02	
This Document has been SUPERSEDED BY					2014-0007/DOA Rev.04	

DOA STATUS

ITA_VC
08:04

14.Oct.2021
Page 4/11

Document-Number	Type	Rev	Compliance	A/C	Subject	Status
Complete document sign-up hierarchy						
2014-0007/DOA Rev.03					A330E MANUFACTURING AND INSTALLATION OF CARPETS	Closed 12.May.2016 W/O:101739863
Replacement Information						
This Document SUPERSEDES					2014-0007/DOA Rev.02	
This Document has been SUPERSEDED BY					2014-0007/DOA Rev.04	
> EOC-331-25-00037-R00/EOC* Rev.00					A330 NEW CARPET INSTALLATION	Closed 12.May.2016 W/O:101739863
Perf Dim1 (D) Perf Dim2 Perf Dim3 W/O Remarks						
12.May.2016 18783:32/H 2'188/C 101739863 Was due at: 20.Apr.2016 PerfRev.: '00'						
2014-0007	DOA	02		A/C	A330E MANUFACTURING AND INSTALLATION OF CARPETS	Superseded (Closed 12.May.2016 W/O:101739863)
Replacement Information						
This Document SUPERSEDES					2014-0007/DOA Rev.01	
This Document has been SUPERSEDED BY					2014-0007/DOA Rev.03	
Complete document sign-up hierarchy						
2014-0007/DOA Rev.02					A330E MANUFACTURING AND INSTALLATION OF CARPETS	Closed 12.May.2016 W/O:101739863
Replacement Information						
This Document SUPERSEDES					2014-0007/DOA Rev.01	
This Document has been SUPERSEDED BY					2014-0007/DOA Rev.03	
> EOC-331-25-00037-R00/EOC* Rev.00					A330 NEW CARPET INSTALLATION	Closed 12.May.2016 W/O:101739863
Perf Dim1 (D) Perf Dim2 Perf Dim3 W/O Remarks						
12.May.2016 18783:32/H 2'188/C 101739863 Was due at: 20.Apr.2016 PerfRev.: '00'						
2014-0007	DOA	05		A/C	A330E MANUFACTURING AND INSTALLATION OF CARPETS	Superseded (Closed 12.May.2016 W/O:101739863)
Replacement Information						

DOA STATUS

ITA_VC
08:04

14.Oct.2021
Page 5/11

For Aircraft , Act.TAH: 38718, Act.TAC: 4454)

Document-Number	Type	Rev	Compliance	A/C	Subject	Status
					This Document SUPERSEDES	2014-0007/DOA Rev.04
					This Document has been SUPERSEDED BY	2014-0007/DOA Rev.06
Complete document sign-up hierarchy						
2014-0007/DOA Rev.05					A330E MANUFACTURING AND INSTALLATION OF CARPETS	Closed 12.May.2016 W/O:101739863
Replacement Information						
					This Document SUPERSEDES	2014-0007/DOA Rev.04
					This Document has been SUPERSEDED BY	2014-0007/DOA Rev.06
> EOC-331-25-00037-R00/EOC* Rev.00					A330 NEW CARPET INSTALLATION	Closed 12.May.2016 W/O:101739863
					Perf Dim1 (D)	Perf Dim2
					Perf Dim3	W/O
					Remarks	
					12.May.2016	18783:32/H 2'188/C 101739863 Was due at: 20.Apr.2016 PerfRev.: '00'
2014-0007	DOA	06		A/C	A330E MANUFACTURING AND INSTALLATION OF CARPETS	Closed 12.May.2016 W/O:101739863
Replacement Information						
					This Document SUPERSEDES	2014-0007/DOA Rev.05
Complete document sign-up hierarchy						
2014-0007/DOA Rev.06					A330E MANUFACTURING AND INSTALLATION OF CARPETS	Closed 12.May.2016 W/O:101739863
Replacement Information						
					This Document SUPERSEDES	2014-0007/DOA Rev.05
> EOC-331-25-00037-R00/EOC* Rev.00					A330 NEW CARPET INSTALLATION	Closed 12.May.2016 W/O:101739863
					Perf Dim1 (D)	Perf Dim2
					Perf Dim3	W/O
					Remarks	
					12.May.2016	18783:32/H 2'188/C 101739863 Was due at: 20.Apr.2016 PerfRev.: '00'
2014-0018	DOA	02	Recommended	A/C	A330 B777 - BUMPER INSTALLATION ON B/C SEATS	Closed 04.Jul.2018 W/O:105117037
Replacement Information						

DOA STATUS

ITA_VC
08:04

14.Oct.2021
Page 6/11

Document-Number	Type	Rev	Compliance	A/C	Subject	Status			
					This Document SUPERSEDES	2014-0018/DOA Rev.01			
Complete document sign-up hierarchy									
					A330 B777 - BUMPER INSTALLATION ON B/C SEATS	Closed 04.Jul.2018 W/O:105117037			
Replacement Information									
					This Document SUPERSEDES	2014-0018/DOA Rev.01			
>					A14062/EOM* Rev.02	A330E B777 - BUMPER INSTALLATION ON B/C SEATS	Closed 04.Jul.2018 W/O:105117037		
Replacement Information									
					This Document SUPERSEDES	A14062/EOM Rev.01			
					Perf Dim1 (D)	Perf Dim2	Perf Dim3	W/O	Remarks
					04.Jul.2018	29637:09/H	3'394/C	105117037	Was due at: 30.Sep.2018 PerfRev.: '02'
2014-0018	DOA	01	Recommended	A/C	A330 B777 - BUMPER INSTALLATION ON B/C SEATS	Superseded (Closed 24.Nov.2014 W/O:101533644)			
Replacement Information									
					This Document has been SUPERSEDED BY	2014-0018/DOA Rev.02			
Complete document sign-up hierarchy									
					A330 B777 - BUMPER INSTALLATION ON B/C SEATS	Closed 24.Nov.2014 W/O:101533644			
Replacement Information									
					This Document has been SUPERSEDED BY	2014-0018/DOA Rev.02			
>					A14062/EOM* Rev.01	A330E B777 - BUMPER INSTALLATION ON B/C SEATS	Closed 24.Nov.2014 W/O:101533644		
Replacement Information									
					This Document SUPERSEDES	A14062/EOM Rev.00			
					This Document has been SUPERSEDED BY	A14062/EOM Rev.02			
					Perf Dim1 (D)	Perf Dim2	Perf Dim3	W/O	Remarks
					24.Nov.2014	12165:00/H	1'419/C	101533644	Was due at: 29.Nov.2014 PerfRev.: '01'
2014-0032	DOA	00	Recommended	A/C	A330 PORTABLE CYLINDER ASSEMBLY (PCA) STANDARDIZATION	Open			
					Due Dim1 (D)	Due Dim2	Due Dim3	New W/O	Time-Requirement of Document

DOA STATUS

ITA_VC
08:04

14.Oct.2021
Page 7/11

Document-Number	Type	Rev	Compliance	A/C	Subject					Status
					No limit					
2014-0037	DOA	00	Recommended	A/C	EXPO2015-LOGO PLACARD INSTALLATION ON FUSELAGE					Closed 20.Oct.2014 W/O:101478809
Complete document sign-up hierarchy										
2014-0037/DOA Rev.00					EXPO2015-LOGO PLACARD INSTALLATION ON FUSELAGE					Closed 20.Oct.2014 W/O:101478809
> EOC-ALL-11-00001-R00/EOC* Rev.00					EXPO2015-LOGO PLACARD INSTALLATION ON FUSELAGE					Closed 20.Oct.2014 W/O:101478809
		Perf Dim1 (D)	Perf Dim2	Perf Dim3	W/O	Remarks				
		20.Oct.2014	11723:00/H	1'360/C	101478809	Was due at: 20.Oct.2014 PerfRev.: '00'				
2014-0045	DOA	00	Recommended	A/C	A330 B777 IFE OPERATING INSTRUCTION PLACARD					Superseded (Closed 28.Dec.2014 W/O:101538782)
Replacement Information										
This Document has been SUPERSEDED BY					2014-0045/DOA Rev.01					
Reason for this Status										
Manually deassigned after Document Cancelled or Superseded										
Complete document sign-up hierarchy										
2014-0045/DOA* Rev.00					A330 B777 IFE OPERATING INSTRUCTION PLACARD					Closed 28.Dec.2014 W/O:101538782
Replacement Information										
This Document has been SUPERSEDED BY					2014-0045/DOA Rev.01					
Reason for this Status										
Manually deassigned after Document Cancelled or Superseded										
> A14140/EOM* Rev.00					A330 B777 - IFE OPERATING INSTRUCTION PLACARD					Closed 28.Dec.2014 W/O:101538782
		Perf Dim1 (D)	Perf Dim2	Perf Dim3	W/O	Remarks				
		28.Dec.2014	12633:00/H	1'475/C	101538782	Was due at: 30.Dec.2014 PerfRev.: '00'				
2014-0048	DOA	00	Recommended	A/C	ALITALIA FLEET - ETIHAD PARTNER STICKER MANUFACTURING AND INSTALL.					Closed 17.Jan.2015 W/O:101581079
Complete document sign-up hierarchy										

DOA STATUS

ITA_VC
08:04

14.Oct.2021
Page 8/11

Selection: DESIGN ORGANISATION APPROVAL

Only Open Documents , Closed Documents

Document-Number	Type	Rev	Compliance	A/C	Subject					Status
					2014-0048/DOA Rev.00					Closed 17.Jan.2015 W/O:101581079
					> EOC-ALL-11-00002-R00-G/EOC* Rev.00					Closed 17.Jan.2015 W/O:101581079
					Perf Dim1 (D)	Perf Dim2	Perf Dim3	W/O	Remarks	
					17.Jan.2015	12853:00/H	1'502/C	101581079	Was due at: 21.Jan.2015 PerfRev.:00'	
2015-0004	DOA	02	Optional	A/C	EPA PLACARDS FOR A320 & A330 FAMILY AIRCRAFT					Closed 15.Jan.2018 W/O:105056745 / Special Text: REF. AIPC A330 TR 11-005 ALI & ST A15003R02
					Replacement Information					
					This Document SUPERSEDES				2015-0004/DOA Rev.01	
					Complete document sign-up hierarchy					
					2015-0004/DOA Rev.02					Closed 15.Jan.2018 W/O:105056745 / Special Text: REF. AIPC A330 TR 11-005 ALI & ST A15003R02
					Replacement Information					
					This Document SUPERSEDES				2015-0004/DOA Rev.01	
					> EOC-331-11-00009-R00/EOC* Rev.00					Closed 22.Nov.2016 W/O:103649980
					Perf Dim1 (D)	Perf Dim2	Perf Dim3	W/O	Remarks	
					22.Nov.2016	21691:46/H	2'519/C	103649980	Was due at: 30.Nov.2016 PerfRev.:00'	
					> EOC-331-11-00010-R00/EOC* Rev.00					Closed 15.Jan.2018 W/O:105056745
					Perf Dim1 (D)	Perf Dim2	Perf Dim3	W/O	Remarks	
					15.Jan.2018	27241:18/H	3'139/C	105056745	Was due at: 31.May.2018 PerfRev.:00'	
					> EOC-331-11-00011-R00/EOC* Rev.00					Not Applicable by Serial Number

DOA STATUS

ITA_VC
08:04

14.Oct.2021
Page 9/11

Document-Number	Type	Rev	Compliance	A/C	Subject	Status
2015-0014	DOA	00	Recommended	A/C	DECORATIVE LAMINATE REPLACEMENT ON CABIN MONUMENTS	Closed 12.May.2016 W/O:101723121
Complete document sign-up hierarchy						
2015-0014/DOA Rev.00					DECORATIVE LAMINATE REPLACEMENT ON CABIN MONUMENTS	Closed 12.May.2016 W/O:101723121
> EOC-331-25-00040-R00-G/EOC* Rev.00					DECORATIVE LAMINATE REPLACEMENT DUE TO CABIN INTERIOR RESTYLING	Closed 12.May.2016 W/O:101723121
Perf Dim1 (D)		Perf Dim2	Perf Dim3	W/O	Remarks	
12.May.2016		18783:32/H	2'188/C	101723121	Was due at: 14.Jul.2016 PerfRev.: '00'	
2015-0020	DOA	00	Recommended	A/C	A330 ACFT - RECARO ECONOMY AND ECONOMY SEATS - EPA SEAT DRESS COVERS MANUFACTURING AND INSTALLATION	Closed 12.May.2016 W/O:101831333
Complete document sign-up hierarchy						
2015-0020/DOA Rev.00					A330 ACFT - RECARO ECONOMY AND ECONOMY SEATS - EPA SEAT DRESS COVERS MANUFACTURING AND INSTALLATION	Closed 12.May.2016 W/O:101831333
> EOC-331-25-00056-R00/EOC* Rev.00					A330 ACFT FLEET - RECARO PREMIUM ECONOMY AND ECONOMY SEATS - DOA PROJECT N. 2015-0020 PLACARD APPLICATION	Closed 12.May.2016 W/O:101831333
Perf Dim1 (D)		Perf Dim2	Perf Dim3	W/O	Remarks	
12.May.2016		18783:32/H	2'188/C	101831333	Was due at: 29.Apr.2016 PerfRev.: '00'	
2016-0027	DOA	00	Recommended	A/C	RESTORE OF THE ADB REDUNDANCY	Closed 19.Jan.2017 W/O:103476500
Complete document sign-up hierarchy						
2016-0027/DOA Rev.00					RESTORE OF THE ADB REDUNDANCY	Closed 19.Jan.2017 W/O:103476500
> EOC-331-23-00007-R00/EOC* Rev.00					RESTORE OF THE ADB REDUNDANCY	Closed 19.Jan.2017 W/O:103476500
Perf Dim1 (D)		Perf Dim2	Perf Dim3	W/O	Remarks	
19.Jan.2017		22452:35/H	2'603/C	103476500	Was due at: 15.Jan.2017 PerfRev.: '00'	

DOA STATUS

ITA_VC
08:04

14.Oct.2021
Page 10/11

Document-Number	Type	Rev	Compliance	A/C	Subject	Status
2021-0006	DOA	00	Mandatory	A/C	ITA ACFT FLEET - EXTERNAL LOGO APPLICATION	Closed 10.Aug.2021 W/O:108818236
Complete document sign-up hierarchy						
					2021-0006/DOA Rev.00	ITA ACFT FLEET - EXTERNAL LOGO APPLICATION Closed 10.Aug.2021 W/O:108818236
					>> A21041/EOM* Rev.00	"OPERATED BY ITA" STICKER APPLICATION ON EXTERNAL FUSELAGE A330 ACFT Closed 10.Aug.2021 W/O:108818236
					Perf Dim1 (D)	Perf Dim2
					10.Aug.2021	38717:13/H
					Perf Dim3	W/O
					4'453/C	108818236
					Remarks	Was due at: 10.Aug.2021 PerfRev.: '00'
LT15MCA00003429	DOA	00	Recommended	A/C	CURTAIN RENEWAL AIRBUS A330 ALITALIA FLEET	Closed 12.May.2016 W/O:101782706
Complete document sign-up hierarchy						
					LT15MCA00003429/DOA Rev.00	CURTAIN RENEWAL AIRBUS A330 ALITALIA FLEET Closed 12.May.2016 W/O:101782706
					> A15104/EOM* Rev.00	A330 ACFT - PASSENGER CABIN CURTAINS REPLACEMENT Not Applicable by Serial Number
					> EOC-331-25-00055-R00/EOC* Rev.00	PASSENGER CABIN CURTAINS REPLACEMENT Closed 12.May.2016 W/O:101782706
					Perf Dim1 (D)	Perf Dim2
					12.May.2016	18783:32/H
					Perf Dim3	W/O
					2'188/C	101782706
					Remarks	Was due at: 20.Apr.2016 PerfRev.: '00'
LT15MCA00003446	DOA	00	Recommended	A/C	RECARO 3510 - E/C SEAT COVERS MANUFACTURING	Closed 12.May.2016 W/O:101780966
Complete document sign-up hierarchy						
					LT15MCA00003446/DOA Rev.00	RECARO 3510 - E/C SEAT COVERS MANUFACTURING Closed 12.May.2016 W/O:101780966
					> A15103/EOM* Rev.00	A330 ACFT - RECARO PEC & EC SEATS - SEAT COVERS REPLACEMENT Not Applicable by Serial Number
					> EOC-331-25-00038-R00/EOC* Rev.00	A330 ACFT - RECARO PEC & EC SEATS - SEAT COVERS REPLACEMENT Closed 12.May.2016 W/O:101780966
					Perf Dim1 (D)	Perf Dim2
					Perf Dim3	W/O
					Remarks	