

2024/2025 AIRBUS A320-251Neo x 10



Aircraft Total Time: 0.0

Total Cycles: 0.0

Date of MFG: 2024/2025

Engine # 1:	Model: CFMI LEAP 1A26	TSN: 0.0	CSN: 0.0
Engine # 2:	Model: CFMI LEAP 1A26	TSN: 0.0	CSN: 0.0
APU:	Honeywell	Model: GTCP 131-9(A)	PN: 3800708-1

Weights and Capacities

Weights	(kg)
MTOW (Maximum Takeoff Weight)	77,000
MTW (Maximum Taxi Weight)	77,400
MLW (Maximum Landing Weight)	67,400
MZFW (Maximum Zero Fuel Weight)	64,300
OEW (Operational Empty Weight)	40,300
Maximum Usable Fuel Capacity	19,087

ETOPS capability 120 Minutes + (to be EASA Certified)	Area Navigation (P-RNAV / B-RNAV)	Weights and Temp Units
Flight Deck Exterior Surveillance System	Approach Category: CAT IIIB	(SI) of units and US Standard units

## Landing Gear

LDG Maintenance Status	<u>Nose</u>	<u>LH MAIN GEAR</u>	<u>RH MAIN GEAR</u>
TSN (hours)	0.0	0.0	0.0
CSN (cycles)	0.0	0.0	0.0
Effective Date	1/24	1/24	1/24
Date Overhauled	N/A	N/A	N/A
Interval (Months / Cycles)	120 MO / 18,000 CYC	120 MO / 18,000 CYC	120 MO / 18,000 CYC
Estimated Next Shop Visit	JAN 2034 / 18,000	JAN 2034 / 18,000	JAN 2034 / 18,000

## Maintenance Schedule

Base HM-check interval	7,500 FH & 5,000 FH & 24 MO
A - Check interval	750 FH&750FC&121 Days
Last HM Check performed	N/A
Next HM Maintenance Check	7,500 FH & 5,000 FH & 24 MO
Status Date	01 Jan 2024

## Interior Configuration

<b>Seat Economy</b>	<b>186 Y</b>	<b>28" Average</b>	
Galley	2 (G1; G4B)	Catering Standard	ATLAS
Attendant Seats	5	Cargo Configuration	All Bulk + No CLS
In Flight Entertainment	None	Lavatory	3

Seats are not installed. Customer may install its own BFE or ask for a specific Part Number and Type.  
Leadtime and cost shall be considered.

## LOPA

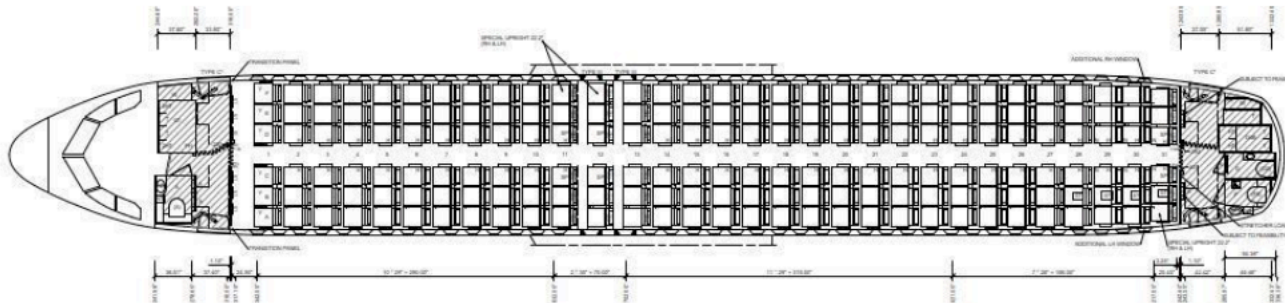

## MAJOR AVIONICS EQUIPMENT

Description	Manufacturer	Part Number	QTY
<b>ATA 22 - Automatic Flight Controls</b>			
Flight Augmentation Computer	Thales Avionics	C13206AA00	2
Flight Management Guidance Computer	Thales Avionics	C13207CA00	2
<b>ATA 23 – Communication</b>			
Radio Management Panel	Thales Avionics	C12848CB01	2
Audio Management Unit	Team	AMU4031SA140204	1
Audio Control Panel	Team	ACP2788AD01	3
Transceiver VHF/COMM	Honeywell	965-1696-051	3
Transceiver HF/COMM	N/A		
<b>ATA 31 - Indication and Recording System</b>			
Solid State Flight Data Recorder	Honeywell	980-4750-002	1
Solid State Cockpit Voice Recorder	Honeywell	980-6032-023	1
Flight Warning Computer	AIRBUS	350E053021414	2
FDIMU (Flight Data Interface Management Unit)	Teledyne	2234320-02-02	1
SFDIU	Thales Avionics	C12860AA04	1
<b>ATA 34 – Navigation</b>			
MMR - Multi Mode Receiver ILS/GPS	Honeywell	822-1152-122	2
ADIRU (Air Data Inertial Reference Unit)	Honeywell	HG2030BE04	3
Weather Radar (WRX)	Honeywell	930-1005-002	1
TCAS II 7.1 Computer	Honeywell	940-0351-001	1
ATC-Mode S Transponder	Honeywell	066-01127-1402	2
Radio Altimeter Transceiver (RA)	Honeywell	066-50007-0432	2
EGPWS	Honeywell	69000942-151	1
VOR Receiver	Honeywell	69001410-200	2
DME Interrogator	Honeywell	066-50013-1222	2
ADF Receiver	N/A		

SCN MSCN MISC	EPAC TDU	TITLE
<b>ATA 02 CERTIFICATION - EXTERNAL LIVERY</b>		
SCN	CN02.10.120/01	15 knots tailwind certification at Take-Off
SCN	CN02.12.129/01	Certification of A320 increased seating capacity up to 186 seats
SCN	CN02.40.116/01	External livery
SCN	CN02.10.111/01	Compliance with EASA type certification requirements (A319/A320/A321)
<b>ATA 03 MISCELLANEOUS</b>		
SCN	CN03.20.551/53	A320-251N design weights - increased MTOW to 77 t, MLW to 67.4 t, MZFW to 64.3 t (WV 053)
<b>ATA 11 PLACARDS AND MARKINGS - GENERAL</b>		
SCN	CN11.00.124/03	Installation of leasing identification plates on LH door frame
SCN	CN11.00.124/09	Installation of leasing identification plates on engines
SCN	CN11.30.122/46	Installation of placard for cabin access restriction
SCN	CN11.30.110/04	Passenger placards and signs alternate marking - English only
SCN	CN11.00.123/02	Aircraft certification holders in flight compartment and cabin
SCN	CN11.30.131/05	Installation of weight placard on each overwing hatch
SCN	CN11.20.125/05	Red RVSM markings around static ports
SCN	CN11.20.119/13	External livery - Nose landing gear towing angle markings
SCN	CN11.30.111/32	Monolingual EEPMS exit identifier - English only (vertical arrangement) - AIRSIGNA
<b>ATA 21 AIR CONDITIONING - GENERAL</b>		
SCN	CN21.50.100/01	Installation of an insulation cover for ozone converters
SCN	CN21.70.109/07	Installation of ozone catalytic converters - BASF CORPORATION, PN.20499006
MSCN	CN21.61.000/01	Introduce improved Air Conditioning System Controller P/N 1803B0000-03
MSCN	CN21.61.000/02	Introduce improved Air Conditioning System Controller P/N 1803B0000-04
<b>ATA 23 COMMUNICATIONS - GENERAL</b>		
SCN	CN23.00.132/44	Auto. progr. ELT (406 AFN) assoc. with remote control panel in cockpit w/o AIM - HONEYWELL (BFE)
SCN	23D7300100E	<b>CIDS CHANGES</b> Includes: <ul style="list-style-type: none"> <li>- Call chime via all C/A station and passenger compartment loudspeakers</li> <li>- EVAC command push button at additional attendant panel</li> <li>- Guard for EVAC command button at additional attendant panel</li> <li>- Customer provided (picture) screensaver</li> </ul>
SCN	CN23.12.130/16	VHF Data Radio (VDR) alternate equipment, capable VDL mode 2 - HONEYWELL
SCN	CN23.51.136/27	Boomsets alternate equipment - TELEX COMMUNICATIONS, PN 64300-210
SCN	CN23.71.103/21	SSCVR alternate equipment - HONEYWELL, PN 980-6032-023 (90 days ULB)
SCN	CN23.71.110/01	Recorder Independent Power Supply (RIPS) - 28VDC power supply for CVR
SCN	CN23.71.120/01	System provision for CVR capable of data link recording
MSCN	CN23.71.001/04	Introduce CAM DMS8 for ED112 mandate compliance
<b>ATA 24 ELECTRICAL POWER - GENERAL</b>		
MSCN	CN24.22.000/06	Introduce GCU P/N 767584M
<b>ATA 25 EQUIPMENT/FURNISHINGS - GENERAL</b>		
SCN	CN25.11.208/05	Installation of fourth occupant seat in cockpit (without oxygen mask) - STELIA AEROSPACE
SCN	25D5000100E	<b>CARGO HOLD CONFIGURATION</b> Includes: <ul style="list-style-type: none"> <li>- Installation of rubber seal profiles for floor panels in FWD and AFT cargo holds</li> <li>- Basic full bulk configuration - without ACT provision</li> <li>- Reinforced floor panels in FWD &amp; AFT cargo holds - with full bulk configuration</li> </ul>
SCN	CN25.65.196/72	Installation of provision for emergency equipment
SCN	CN25.33.619/01	Installation of wet galley at loc. IVB - 3 FS and 2 HS trolleys - Space-Flex galleys (SFE)
SCN	GN25.43.470/03	Space-Flex lavatory module Fs/Gs in comb. with galley loc. IVB - aft of aft LH PAX/crew/service door
SCN	CN25.35.131/20	Installation of Minimum non-electrical galley catering equipment (BFE)
SCN	CN25.33.639/08	Installation of specific options on galley at loc. IVB
SCN	GN25.22.212/01	Single wall-mounted C/A seat (16G) at loc. 62 - on lavatory door at aft PAX/Crew/Service door area
SCN	CN25.43.471/08	Installation of options on Space-flex lavatories Fs and Gs
SCN	25D3000100E	Galley and galley catering definition
SCN	CN25.22.002/22	Installation of 16G cabin attendant seat 21XX SERIES as per customized cabin layout
SCN	CN25.21.105/42	Non-Installation of Passenger Seats
SCN	CN25.26.133/04	Provisions for curtains
SCN	CN25.26.201/04	Installation of 16G full-height partition for double C/A seat FWD of aft RH PAX/Crew/Service door
SCN	CN25.26.140/54	Installation of cranked windscreen (SFE) LH



SCN	25D2000200E	<b>CABIN LAYOUT DEFINITION</b> Includes: - Cabin Layout ref.320-25.42492 Rev B2 - 186pax (186 Y/C) (*) Including: - Door 1: 1 SFE Lav - 1 G1 WET SFE Galley Cluster 1 (4T) - 2 SFE Partitions - 2 SFE CAS - Door 2: 2 SFE Space Flex V2 Lavatories - 1 SFE SG48 WET Space Flex V2 Galley (G48 w/ 8HS/T) - 2 SFE Partitions - 3 SFE CAS (*) Seats not installed at time of delivery
SCN	CN25.20.001/01	Additional sealing for gaps closure in Galleys, Lavatories and entrance areas
SCN	25D0000100E	<b>CABIN EMERGENCY EQUIPMENT</b> Emergency Equipment drawing ref. 320-80.19045 rev B4
SCN	CN25.23.500/01	Interior colour scheme definition ICS ref. ICS 15/071 Issue 4
SCN	CN25.35.132/06	Non installation of non-electrical galley catering/loose equipment (BFE)
SCN	CN25.28.103/02	Installation of double-sided adhesive tape for carpet
SCN	CN25.28.200/75	NTF selection (SFE standard I) - SCHNELLER AerFusion eco - 95R
SCN	CN25.62.102/17	Installation of slide rafts at FWD and AFT PAX/Crew/Service doors (SFE) - AIR CRUISERS (A320)
SCN	CN25.62.105/07	Survival kits (4) selection (SFE) - AIR CRUISERS, PN 60128-301
SCN	CN25.65.002/12	Cockpit flashlights alternate equipment (SFE) - DME CORPORATION P2-07-0015-002
MSCN	CN25.62.090/07	Install additional wrapper for FWD and aft door slides
MSCN	CN25.65.001/32	Install crash axe P/N E1576014-10000
<b>ATA 26 FIRE PROTECTION - GENERAL</b>		
MSCN	CN26.10.000/07	Install FDU Meggitt P/N 909012-02-01 (engine & APU)
MSCN	CN26.24.100/05	Standardize portable fire extinguisher TOTAL 74-20 in cockpit
<b>ATA 27 FLIGHT CONTROLS - GENERAL</b>		
MSCN	CN27.40.000/09	Introduce Trimmable Horizontal Stabilizer (THS) actuator P/N 47145-268
<b>ATA 28 FUEL - GENERAL</b>		
MSCN	CN28.42.100/17	A319 Neo / A320 Neo - Introduce common fuel gauging
<b>ATA 29 HYDRAULIC POWER - GENERAL</b>		
MSCN	CN29.10.110/0	Introduce improved EDP Eaton P/N 3031863-002
<b>ATA 31 INDICATING/RECORDING SYSTEMS - GENERAL</b>		
SCN	CN31.00.107/14	Imperial units for indicators and labels
SCN	CN31.36.107/03	Full provision for Wireless Ground Link DAR (WGL-DAR) (ARINC 591/600)
SCN	CN31.33.200/23	SSFDR alternate equipment (1024 w/s capable) - HONEYWELL (90 days ULB)
MSCN	CN31.36.100/05	Introduce Flight Data Interface & Management Unit (FDIMU) P/N 2234320-02-02
MSCN	CN31.53.100/14	Introduce FWC H2F8 P/N 350E053021414
MSCN	CN31.53.100/16	Introduce FWC H2F9C
MSCN	CN31.60.000/11	Introduce EIS2-S13.1 software
<b>ATA 32 LANDING GEAR - GENERAL</b>		
SCN	CN32.40.113/32	Wheels and brakes alternate equipment (DURACARB) - GOODRICH
SCN	CN32.48.200/12	Installation of universal brake cooling fans on BF-GOODRICH wheels and brakes
SCN	CN32.41.111/25	MLG tires selection - BRIDGESTONE (46X17-R20 radial tires)
SCN	CN32.41.120/12	NLG tires selection - BRIDGESTONE (30X8.8-R15 radial tires)
MSCN	CN32.11.001/10	Optimize corrosion protection on the MLG main fitting
MSCN	CN32.21.100/10	Introduce "EV2" NLG
MSCN	CN32.42.105/10	Introduce BSCU LA.10 P/N E21327007
<b>ATA 33 LIGHTS - GENERAL</b>		
SCN	CN33.50.118/01	Installation of floor-mounted EEPMS LUFTHANSA TECHNIK -1000 / Exit identifier - AIRSIGNA
SCN	CN33.50.122/16	Installation of Titanium Grey floor-mounted EEPMS LUFTHANSA TECHNIK -1000 - whole cabin
MSCN	CN33.10.106/03	Introduce LED integral lighting system units
MSCN	CN33.12.109/06	Introduce LED technology in the cockpit
MSCN	CN33.40.103/06	Introduce LED technology external lights
MSCN	CN33.40.103/08	Introduce LED technology wing tip lights - Sharklets
MSCN	CN33.48.101/02	Introduce Sharklet strobe lights with shutter concept
<b>ATA 34 NAVIGATION - GENERAL</b>		
SCN	CN34.00.300/02	RNP AR / SAAAR capability (STEP 3)
SCN	CN34.43.204/01	TCAS change 7.1 - HONEYWELL TPA-100B / ATC XPDR - HONEYWELL (-1402)
SCN	CN34.42.117/01	Radio altitude automatic call-outs
SCN	CN34.53.121/01	Non installation of ADF system
SCN	CN34.58.313/22	MMR alternate equipment providing ILS (FM immunity) and GPS C1 functions - HONEYWELL
SCN	CN34.20.203/02	ISIS optional function - BARO setting
SCN	CN34.41.302/07	Alternate full single WXR (ARINC 708A) with weather ahead - HONEYWELL RDR-4000 V2
SCN	CN34.42.101/19	Radio altimeters alternate equipment - HONEYWELL, PN 066-50007-0432
SCN	CN34.43.290/01	Wiring provision for Aircraft Traffic Situation Awareness (ATSAW)
SCN	CN34.51.101/13	DME interrogators alternate equipment - HONEYWELL, PN 066-50013-1222
SCN	CN34.52.117/02	Compliance with ADS-B OUT regulation for NRA
SCN	CN34.55.102/14	VOR/MARKER receivers alternate equipment - HONEYWELL, PN 69001410-200

<b>ATA 35 OXYGEN - GENERAL</b>		
SCN	CN35.32.500/49	Installation of PBE in cabin (BFE) - ESSEX, PN MR10049NA
SCN	CN35.20.010/01	Installation of four oxygen masks per box
SCN	CN35.20.115/01	Alternate lavatory gaseous oxygen supply (15 min)
MSCN	CN35.10.000/05	Introduce cockpit oxygen segregation for neo a/c
<b>ATA 38 WATER/WASTE – GENERAL</b>		
SCN	CN38.10.102/04	Provide a compliance statement with USPHS handbook on sanitation
SCN	CN38.31.111/01	Installation of an improved toilet assembly
SCN	CN38.12.119/03	Lavatory water faucet flow time adjustment to 5 seconds
<b>ATA 46 INFORMATION SYSTEMS – GENERAL</b>		
SCN	CN46.21.102/16	AIRBUS standard AOC software from HONEYWELL with units in Lbs
<b>ATA 49 AIRBORNE AUXILIARY POWER - GENERAL</b>		
SCN	CN49.00.105/21	APU alternate equipment - HONEYWELL, GTC131-9A
MSCN	CN49.00.106/10	Introduce A320 Neo entry into service APU ECB standard
<b>ATA 51 STANDARD PRACTICES AND STRUCTURES - GENERAL</b>		
SCN	CN51.22.510/18	PPG Matt clear coat below front cockpit windows
SCN	CN51.22.705/02	Alternate paint system (CF primer, Base Coat/Clear Coat) on fuselage & vert. stabilizer - ANAC
SCN	CN51.22.705/04	Alternate paint system (CF primer, Base Coat/Clear Coat) on nacelles - ANAC
SCN	CN51.22.260/50	Decorative adhesive film (SFE)
<b>ATA 55 STABILIZERS – GENERAL</b>		
SCN	CN55.30.101/01	Installation of erosion protection on vertical stabilizer leading edge - stainless steel
<b>ATA 56 WINDOWS - GENERAL</b>		
SCN	CN56.10.102/23	Alternate lateral windows - SAINT-GOBAIN SULLY
SCN	CN56.10.102/32	Alternate front windows - SAINT-GOBAIN SULLY
<b>ATA 57 WINGS – GENERAL</b>		
SCN	CN57.49.101/01	Wing leading edge access panels - removal of sealant
<b>ATA 71 POWER PLANT - GENERAL</b>		
SCN	CN71.02.100/02	Installation of an interphone jack on CFM nacelles
<b>ATA 72 ENGINE - GENERAL</b>		
SCN	CN72.00.220/01	CFM engines - CFM LEAP-1A26 at a thrust rating of 26 600 Lbf (A320-251N)

Specifications represent One 2024 A320-200 neo aircraft.

Three Sister ships available. Specifications are similar.

#### Purchase Terms

- LOI (or draft contract signed) & Mandate.
- The KYC and POF must be submitted to escrow
- Buyer will submit POF and a minimum deposit of 5% of the full purchase value of the aircraft into escrow
  - Escrow Agent Releases MSN to Buyer